

Recommended PANEL CUTOUT
MAX. PANEL THICKNESS
11.0mm [.433]

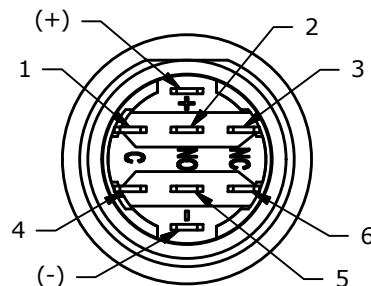

SWITCH FUNCTION	
POS. 1	POS. 2
ON	(ON)
1-3, 4-6	(1-2, 4-5)

() = MOMENTARY

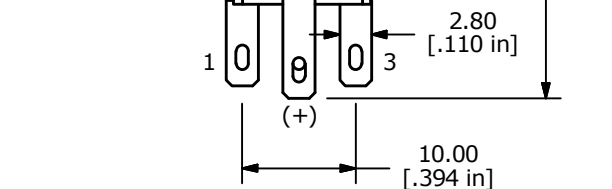
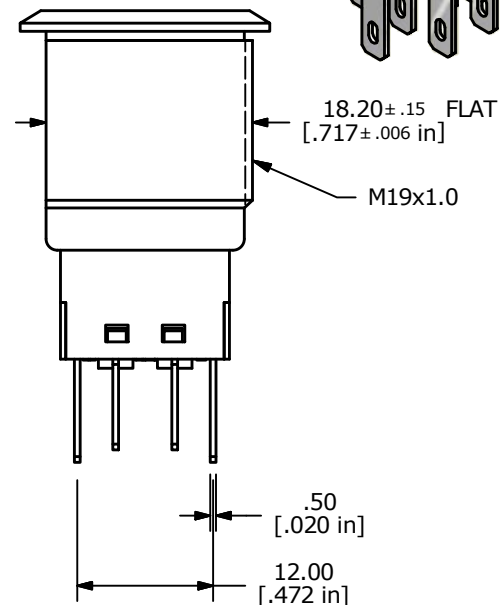
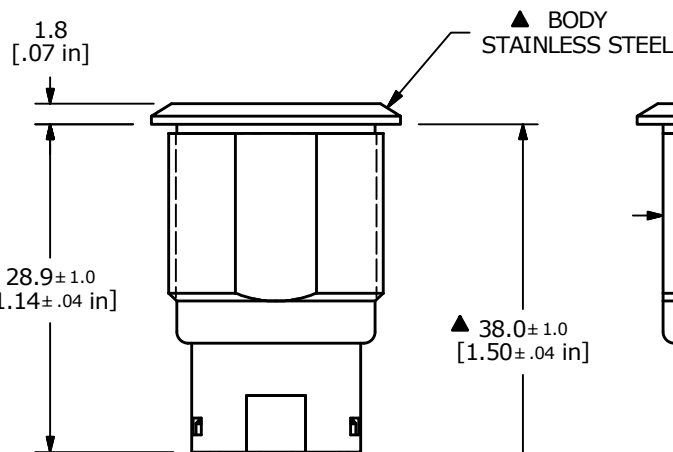
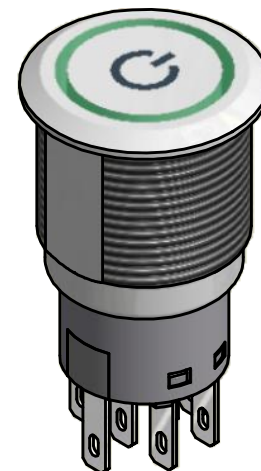
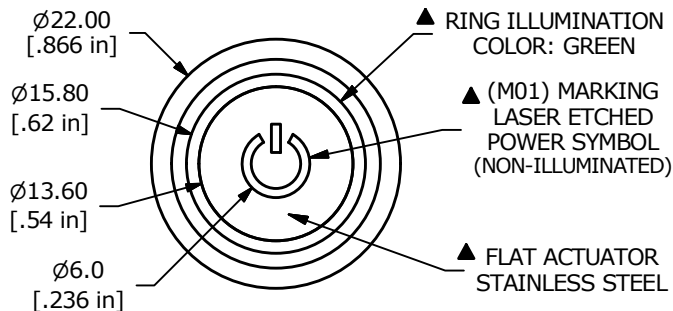
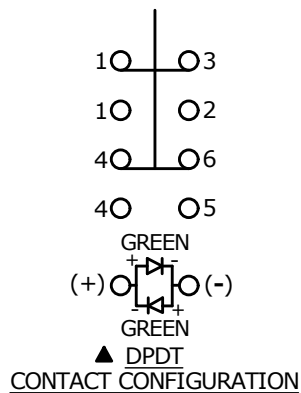

NOTE:

- ALL DIMENSIONS IN mm [INCH]
- GENERAL TOLERANCE: X.X = ±0.4
X.XX = ±0.25
- TERMINAL NUMBERS FOR REF ONLY
- CONTACT MATERIAL: SILVER
- RATING: 2A 24VDC
- ELECTRIC LIFE: 50,000 MAKE-AND-BREAK CYCLES AT FULL LOAD.
- INSULATION RESISTANCE: 1,000 MΩ MIN.
- DIELECTRIC STRENGTH: 2,000 VAC MIN. FOR 1 MINUTE
- CONTACT RESISTANCE: 50mΩ MAX. @ 1A 12VDC
- OPERATING TEMP.: -20°C to 55°C
- TRAVEL: 2.8mm
- ▲ DENOTES CRITICAL PARAMETER.
- INGRESS PROTECTION: IP65
- ▲14. HARDWARE SUPPLIED: O-RING AND HEXNUT
- ▲15. LAMP VOLTAGE: 24V



C	22413	Drawing Updates	8/30/16	MW
B	21451	ADD FLAT, REDRAW IN 3D	5/7/14	EBP
REV	PCR NO	DESCRIPTION	DATE	BY

TITLE PV4F2H0SS-335-M01				
SCALE 3:2	DATE 5/7/2014	DR MW	DWG 52-PV4F2H0SS335M01	REV C

THE INFORMATION CONTAINED IN THIS DOCUMENT IS PROPRIETARY TO E-SWITCH AND IS NOT TO BE COPIED OR TRANSFERRED