

## HC-B 6-SMLD-52/M2PG16

Order No.: 1771189

Photo shows product without screw connection

<http://eshop.phoenixcontact.de/phoenix/treeViewClick.do?UID=1771189>Box mounting base, with single locking latch, height 52 mm, with  
screw connection, 2x Pg16, with protective covers

### Commercial data

GTIN (EAN)	
sales group	D002
Pack	10 pcs.
Customs tariff	85389099
Catalog page information	Page 481 (PC-2009)

### Product notes

WEEE/RoHS-compliant since:  
03/01/2006

<http://www.download.phoenixcontact.com>  
Please note that the data given here has been taken from the online catalog. For comprehensive information and data, please refer to the user documentation. The General Terms and Conditions of Use apply to Internet downloads.

### Technical data

#### General data

Design	B6
Height	52 mm
Width	52 mm
Length	84 mm
Housing type	Box mounting base with cover

Locking type	With single locking latch
Type of the screw connection	2x Pg16
Pg screw connection	With
Wrench size, union nut	22 mm
External cable diameter	7.5 mm ... 15 mm
Protective cover	Yes
Degree of protection	IP65
Ambient temperature (operation)	-40 °C ... 125 °C
Housing material	Aluminum, die-cast
Housing surface material	Powder-coated, gray
Seal material	NBR
Cable gland material	Nickel-plated brass
Cable seal material	NBR
Material lock	High-grade steel, handle: PA-GF
Material grip body interlock	PA-GF
Material, protective cover	PA

### Certificates / Approvals



Certification

GOST

### Diagrams/Drawings

Dimensioned drawing

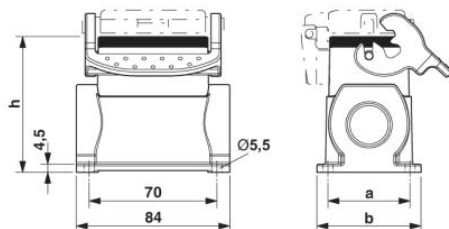

**Address**

PHOENIX CONTACT Deutschland GmbH  
Flachmarktstr. 8  
32825 Blomberg, Germany  
Phone +49 5235 3 12000  
Fax +49 5235 3 41200  
<http://www.phoenixcontact.de>



© 2010 Phoenix Contact  
Technical modifications reserved;