

NOTES:

1. TERMINAL TO BE USED IN HOUSINGS 70066-**** AND 70450-****
2. REFER TO PRODUCT SPECIFICATION PS-71851
3. REFER TO MOLEX OPERATIONS AND SERVICE MANUAL FOR CRIMP DETAILS
4. TERMINAL TO BE USED WITH (0.64)/.025 SQUARE PINS
5. TERMINAL TO BE USED WITH 32-36 AWG STRANDED WIRE WITH (0.64)/.025 MAX. DIA. INSULATION
6. TERMINALS SUPPLIED IN REEL FORM

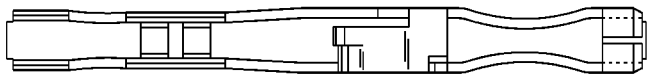

PLATING:

.000015 MIN. GOLD PLATE IN SELECT AREA WITH .000075 MIN. TIN/LEAD PLATE IN SELECT AREA OVER NICKEL PLATE OVERALL

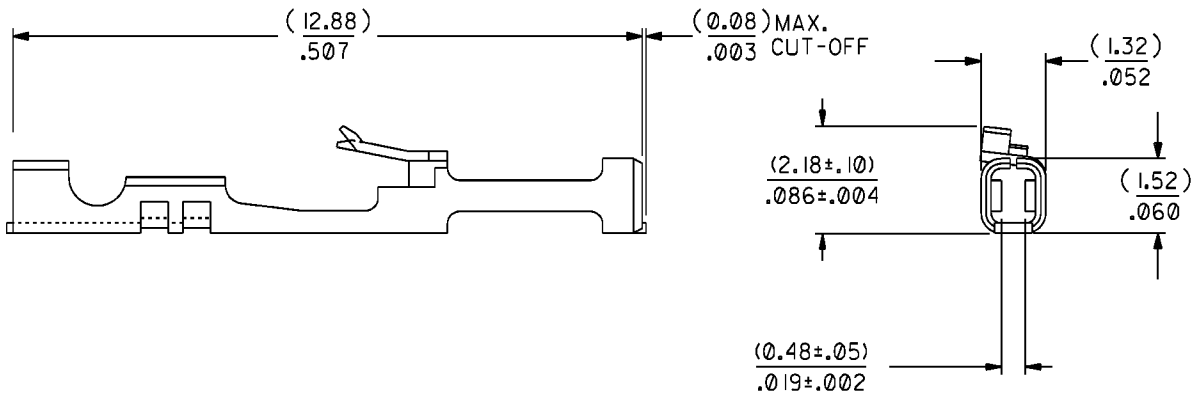

A

			B	REVISE PER ECR* U82219 11-07-88 MJM/MGB
			A	FINAL RELEASE PER ERO *26254 7/14/88 MJM
BI	REVISED ECR *U80270 MCGRATH 97/07/31	3		REVISE PER ERO *26254 3/25/88 MJM
LTR.	REVISIONS	LTR.		REVISIONS

DIMENSIONS SHOWN (METRIC) INCH	
UNLESS OTHERWISE SPECIFIED TOLERANCES: ANGULAR ± 1/2°	
3 PLACE ± .010	---
2 PLACE ± .014	± 0.25
1 PLACE ---	± 0.35
DRAFT WHERE APPLICABLE MUST REMAIN WITHIN DIMENSIONS	
DRWG. BY: MJM	CHK'D. BY: MJM
APP'D. BY: WAZ	SCALE: 10:1

▽ = 0	▼ = 0	REVISE ONLY ON CAD SYSTEM
TITLE TERMINAL-BOX/CRIMP HIGH FORCE CONTACT		
MOLEX INCORPORATED LISLE, ILL. 60532		SHEET NO. 1 DATE 03/25/88
PART NO. 016-02-1120	DRWG. NO. SD-71851-0015	
THIS DRAWING CONTAINS INFORMATION THAT IS PROPRIETARY TO MOLEX INC. AND SHOULD NOT BE USED WITHOUT WRITTEN PERMISSION.		
FILE NAME S71851X43	DIV. DA	SIZE B