

RECOMMENDED PCB LAYOUT (TOP VIEW)

MATERIAL
 INSULATOR: GLASS-REINFORCED THERMOPLASTIC.
 CONTACT: COPPER ALLOY.
 PLATING: MATING AREA - SELECTED GOLD OVER NICKEL.
 SOLDER AREA - TIN/LEAD OVER NICKEL.

ELECTRICAL
 VOLTAGE RATING: 250 VAC RMS.
 CURRENT RATING: 1 AMP.
 DIELECTRIC WITHSTANDING VOLTAGE: 500 VAC RMS 60Hz FOR 1 MINUTE.
 INSULATION RESISTANCE: 1000 MEGOHMS MIN AT 500 VDC.
 CONTACT RESISTANCE: 30 MILLIOHMS MAX.

MECHANICAL
 RETENTION FORCE: 480 GRAMS MIN PER CONTACT.
 INSERTION FORCE: 230 GRAMS MAX PER CONTACT PAIR.
 WITHDRAWAL FORCE: 15 GRAMS MIN PER CONTACT PAIR.

ENVIRONMENTAL
 TEMPERATURE RANGE: -55°C TO +85°C.

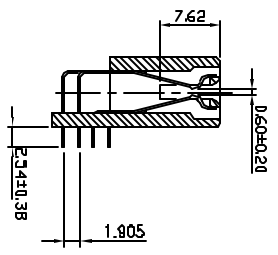

TOLERANCE		ANGLES	
LINEAR	X±0.20	X°±	X'±
	X±0.15	X°±	X'±
	.XX±0.10	.XX°±	
	.XXX±0.05	.XXX°±	

Sullins Electronics
 San Marcos, CA
 www.SullinsElectronics.com

REV	0601	JASON	90.06.01	.XXX±0.05	.XXX°±	DRWN: Jason Deng	QTY:	DWG NO.	T250	UNITS	SCALE	SHEET	REV
										MM	2 : 1	1 OF 1	A

TITLE: 64 BIT PCI CONN , 50V TYPE RIGHT ANGLE

PART NO. TRWB092DKAN-T250

