

PART NUMBER	REV	FIRST USED
680381-2	A	459248-2

THIS DRAWING IS A CONTROLLED DOCUMENT FOR AMP INCORPORATED. IT IS SUBJECT TO CHANGE AND THE CONTROLLING ENGINEERING ORGANIZATION SHOULD BE CONTACTED FOR THE LATEST REVISION.

THIS INFORMATION IS CONFIDENTIAL AND IS DISCLOSED TO YOU ON CONDITION THAT NO FURTHER DISCLOSURE IS MADE BY YOU TO OTHER THAN AMP PERSONNEL WITHOUT WRITTEN AUTHORIZATION FROM AMP INCORPORATED, HARRISBURG, PA.

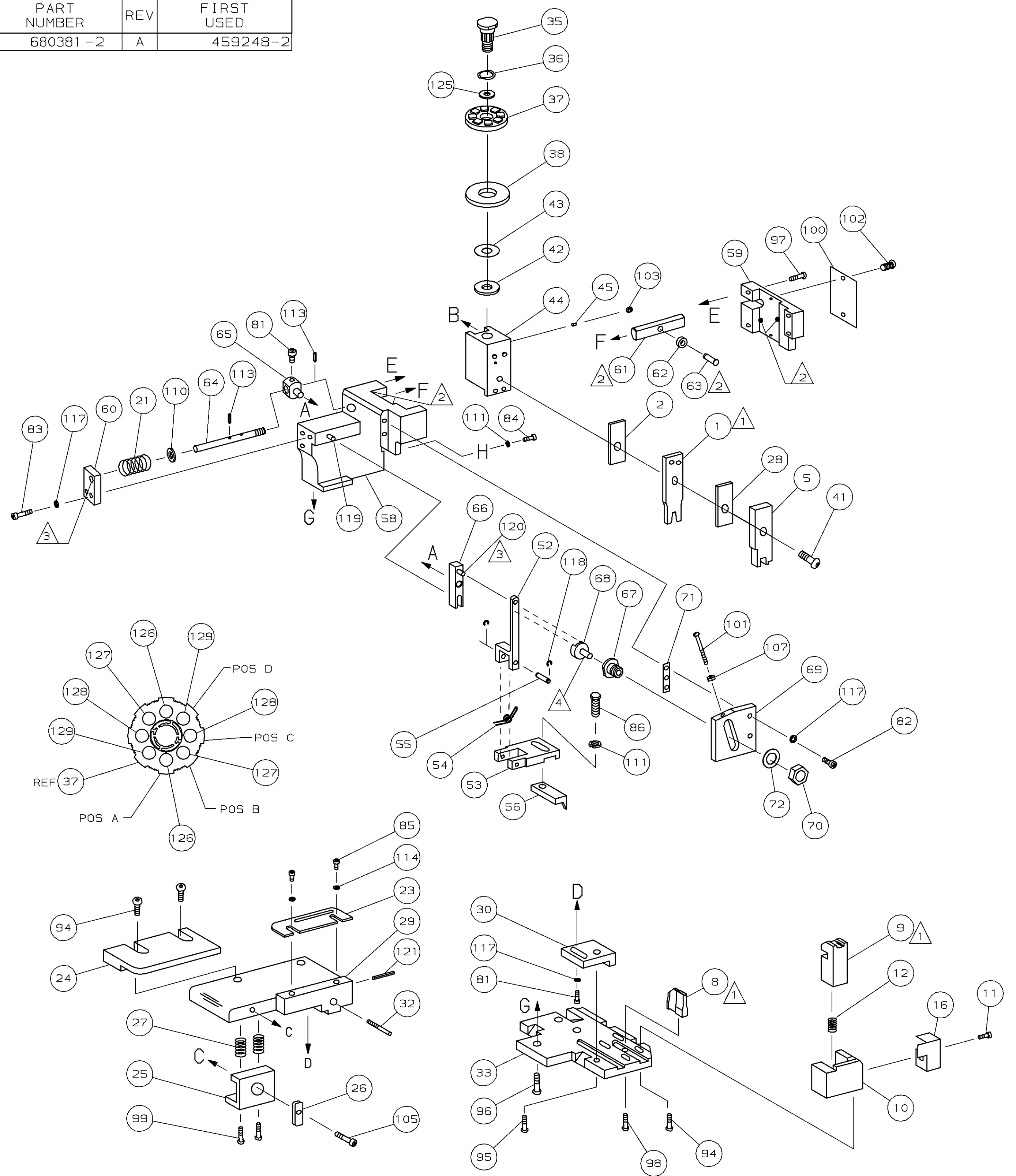

- △ 1 RECOMMENDED SPARE PARTS.
- △ 2 GREASE LIGHTLY.
- △ 3 LUBRICATE DAILY USING NO. 20 MACHINE OIL.

TERMINAL NAME: BRUSH CONTACT					
63930					
CRIMPING DATA					
PAD LTR	CRIMP HEIGHT		WIRE SIZE		
A	.071 ± 0.002 [1.80 ± 0.05mm]		16		
B	.068 ± 0.002 [1.73 ± 0.05mm]		(1)22 & (1)18		
C	.064 ± 0.002 [1.63 ± 0.05mm]		18		
D	.057 ± 0.002 [1.45 ± 0.05mm]		(1)20 OR (1)22		
CRIMP	SIZE	TYPE	RANGE		
WIRE	.090 [2.29mm]	F	22-16		
INSUL	-	-	-		
WIRE STRIP LENGTH	TERM APPL SPEC	FEED	APPL INSTRUCTION	SET UP GAGE	LAYOUT
-	114-2093	.420	408-8040	458637-1	L1838

QTY	REV	U/M	DWG SIZE	PART NO	DESCRIPTION	ITEM NO
2	-	C		6-354779-4	PIN, WIRE DISC (.3310)D	129
2	-	C		4-354779-8	PIN, WIRE DISC (.3230)C	128
2	-	C		4-354779-1	PIN, WIRE DISC (.3195)B	127
2	-	C		3-354779-3	PIN, WIRE DISC (.3155)A	126
1	-	A		986950-1	WASHER, FLAT PRECISION	125
1	-	A		217238-1	GENERAL INSTRUCTION PACKAGE	124
1	-	-		4088040	SF APPL INST 408-8040	123
						122
1	-	A		4-21028-0	PIN,SLT SPR(φ.093x.75)ST 6DE PL	121
1	-	A		1-21030-1	PIN,DOWEL (φ.187x.50)LEVER	120
1	-	A		1-21030-6	PIN,DOWEL (φ.187x1.25)HOUSING	119
2	-	A		21045-3	RING,RET *C*(φ.187)FD FING PIN	118
5	-	A		21024-5	WASHER, LOCK (φ#10)ADJ BLOCK	117
						116
						115
2	-	A		21024-2	WASHER,LOCK (#4)FRONT STP GUIDE	114
2	-	A		5-21028-1	PIN,SLT SPR(φ.125x.50)ADJ ROD	113
						112
2	-	A		21024-4	WASHER,LOCK (#8)STRIPPER	111
1	-	A		21899-4	WASHER,FLAT (φ5/16)SCREW ADJ	110
						109
						108
1	-	A		21018-5	NUT,HEX (6-32)FEED ADJ	107
						106
1	-	A		22353-8	SCR,SHLD (φ.187x.25)DRAG LEVER	105
						104
1	-	A		21009-2	SCR,SKT SET (1/4-20x.25 LW)RAM	103
2	-	A		21017-2	SCR,DRIVE (#2x.19)ID PLATE	102
1	-	A		6-23715-5	SCR,PAN HD (6-32x1.50)FEED ADJ	101
1	-	B		461264-1	PLATE, IDENTIFICATION	100
2	-	A		2-21002-4	SCR,BHC (10-32x.88)DRAG	99
1	-	A		22733-8	SCR,BHC (8-32x.38 LW)ANVIL	98
2	-	A		2-21002-9	SCR,BHC (10-32x.75)CAP	97
3	-	A		2-22733-8	SCR,BHC (1/4-20x.62)HOUSING	96
1	-	A		2-21002-6	SCR,BHC (10-32x.50)SG ADJ BLOCK	95
4	-	A		2-21002-3	SCR,BHC (8-32x.50)TERM H DWN	94
						93
						92
1	-	A		1-21002-7	SCR,BHC (6-32x.38)CAM	91
						90
						89
						88
						87
1	-	A		2-22603-0	SCR,HEX HD (8-32x.31)FEED FINGER	86
2	-	A		1-21000-3	SCR,SHC (4-40x.25)F ST GUIDE	85
1	-	A		2-21000-7	SCR,SHC (8-32x.50)STRIPPER	84
2	-	A		3-21000-7	SCR,SHC (10-32x.75)FEED ROD 6D	83
2	-	A		3-21000-6	SCR,SHC (10-32x.62)FEED ADJ BLK	82
2	-	A		3-21000-4	SCR,SHC (10-32x.38)SG ADJ BL	81
						80
						79
						78
						77
						76
						75
						74
						73
1	-	A		458109-1	WASHER, SPECIAL	72
1	-	A		690517-1	SPACER	71

QTY REQD PER ASSY	U/M	DWG SIZE	PART NO	DESCRIPTION	ITEM NO
PARTS LIST					

QTY REQD PER ASSY	U/M	DWG SIZE	PART NO	DESCRIPTION	ITEM NO
-2	BENCH	CARBON BRUSH		MECH PRE FEED	
1	-	B	22594-8	NUT,HEX (1/2-20)	70
1	-	B	240628-1	PLATE, ADJUSTMENT	69
1	-	B	240626-1	SHAFT, PIVOT	68
1	-	B	240633-1	BUSHING	67
1	-	A	455680-1	LEVER, INTERMEDIATE	66
1	-	B	240629-1	BLOCK, PIVOT	65
1	-	A	240632-2	SCREW, ADJ FEED ROD	64
1	-	B	240659-3	PIN, CAM ROLLER	63
1	-	B	240658-1	ROLLER, CAM	62
1	-	B	454398-2	ROD, FEED	61
1	-	A	454178-1	GUIDE, FEED ROD	60
1	-	C	454220-1	CAP, RAM	59
1	-	D	454485-1	HOUSING	58
					57
1	-	B	1-694433-6	PAWL, FEED	56
1	-	B	240624-1	PIN, FEED FINGER	55
1	-	B	691499-1	SPRING, FEED FINGER	54
1	-	A	690541-1	HOLDER, FEED FINGER	53
1	-	B	455679-1	LEVER, TERMINAL FEED ARM	52
					51
					50
					49
1	-	B	690602-5	CAM, PRE-FEED 1 1/8 ST	48
					47
					46
1	-	A	690191-1	PLUG, NYLON	45
1	-	C	455673-6	RAM	44
1	-	A	690125-1	WASHER, LAMINATED	43
1	-	A	1-690124-1	WASHER, RAM	42
1	-	A	7-21002-9	BOLT, CRIMPER (5/16x1.00)	41
					40
					39
1	-	A	690223-2	SPACER, INSULATION DISC	38
1	-	D	354777-1	WIRE DISC, PLASTIC	37
1	-	A	22480-5	WASHER, SPRING	36
1	-	B	690212-1	POST, RAM	35
					34
1	-	D	610874-3	PLATE, BASE	33
1	-	A	690432-3	SCREW, ADJUSTMENT	32
					31
1	-	B	455689-1	BLOCK, STRIP GUIDE ADJ	30
1	-	C	3-458144-5	PLATE, STRIP GUIDE	29
1	-	C	2-455888-0	SPACER, FRONT SHEAR DEP	28
2	-	A	1-22284-0	SPRING, DRAG	27
1	-	B	240793-1	LEVER, DRAG RELEASE	26
1	-	B	240792-1	DRAG, TERMINAL	25
1	-	D	9-690504-7	GUIDE, STRIP (REAR)	24
1	-	A	690438-1	GUIDE, STRIP (FRONT)	23
					22
1	-	A	4-22284-9	SPRING, FEED RETURN	21
					20
1	-	B	456468-1	STRIPPER	19
					18
					17
1	-	B	318563-1	GUARD, CHIP, FRONT	16
					15
					14
					13
1	-	A	5-22280-0	SPRING, SHEAR	12
1	-	B	690461-1	STOP, SHEAR	11
1	-	C	690459-1	HOLDER, SHEAR (FRONT)	10
1	-	C	454276-1	SHEAR, FLOAT (FRONT)	9
1	-	C	610196-9	ANVIL	8
					7
					6
1	-	C	1-455889-4	DEPRESSOR, SHEAR (FRONT)	5
					4
					3
1	-	C	1-455888-0	SPACER, CRIMPER	2
1	-	C	2-456406-9	CRIMPER, WIRE	1

QTY REQD PER ASSY	U/M	DWG SIZE	PART NO	DESCRIPTION	ITEM NO
REVISION OF EACH ASSY NO (WHEN BLANK, USE DWG REVISION)					
PARTS LIST					
DIMENSIONS IN INCHES. DO NOT SCALE PRINT. TOLERANCES UNLESS OTHERWISE SPECIFIED.					
2 PLC DEC ±					
3 PLC DEC ±					
4 PLC DEC ±					
ANGLES ±					
SURF TEXTURE: ✓					
REMOVE BURRS, BREAK SHARP EDGES R.015 MAX					
MATL	-	HT TR	-	FIN	-
DR	300CT96	APP	10-29-96	J. DODDS	
CHK	10-29-96	REL	-	C. ERISMAN	
NAME: SIDE FEED HDM APPLICATOR				MACHINE REF	MINI APPL
SCALE	-	DWG NO	680381	SHEET	1 OF 1