

- 1 MOLDED PARTS: FLAME RETARDANT, 94V-0 RATED, GLASS FILLED NYLON OR POLYESTER, BLACK
CONTACTS: BRASS
HARDWARE: BRASS
- 2 CONTACTS: SEE TABLE
INSERTS: UNPLATED
SCREWLOCKS: NICKEL PLATED
- 3 REFER TO APPLICATION SPEC FOR RECOMMENDED P.C. BOARD MOUNTING DIMENSIONS FOR AUTOMATIC INSERTION.
- 4 GOLD FLASH ON THE MATING SURFACES, $.000100$ MIN TIN OR TIN-LEAD PLATE ON THE SOLDER END, $.000050$ MIN NICKEL UNDERPLATE ON THE ENTIRE CONTACT.
- 5 $.000030$ MIN GOLD PLATE ON THE MATING SURFACES, $.000100$ MIN TIN OR TIN-LEAD PLATE ON THE SOLDER END, $.000050$ MIN NICKEL UNDERPLATE ON THE ENTIRE CONTACT.
-OR-
GOLD FLASH OVER PALLADIUM- NICKEL PLATE, $.000030$ MIN TOTAL ON THE MATING SURFACES, $.000100$ MIN TIN OR TIN-LEAD PLATE ON THE SOLDER END, $.000050$ MIN NICKEL UNDERPLATE ON THE ENTIRE CONTACT.

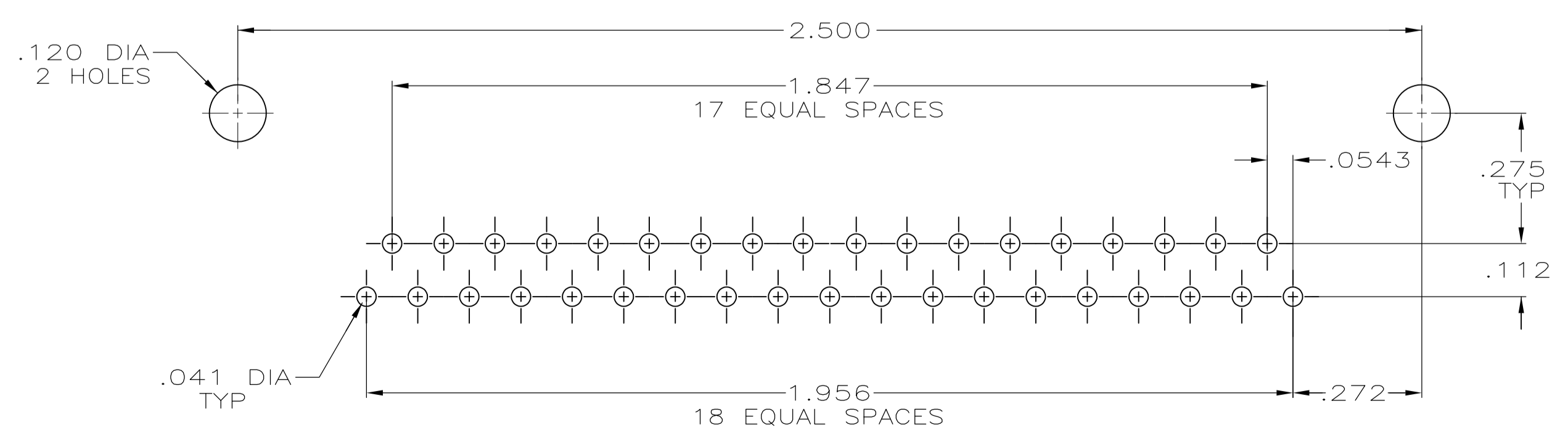
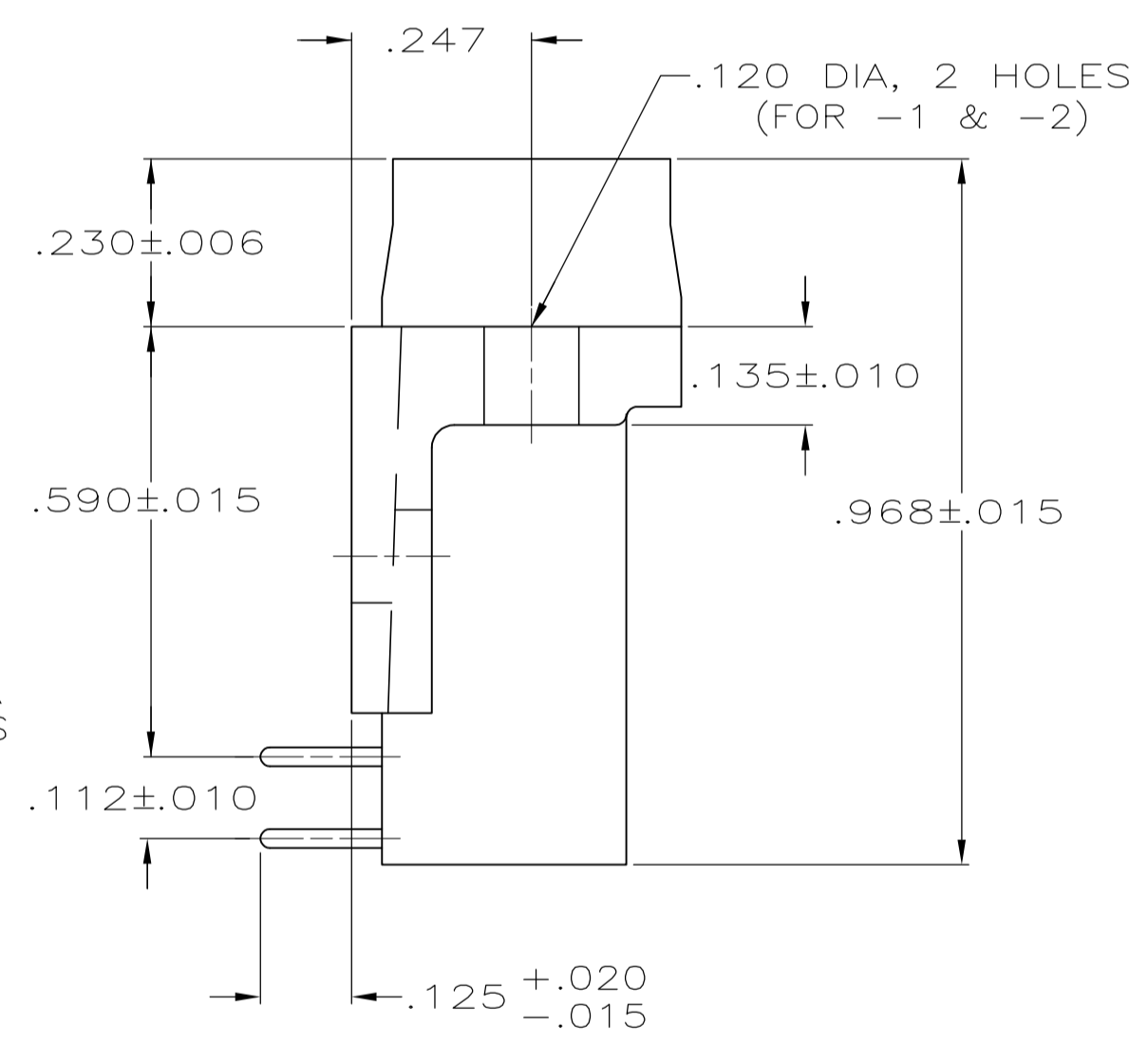
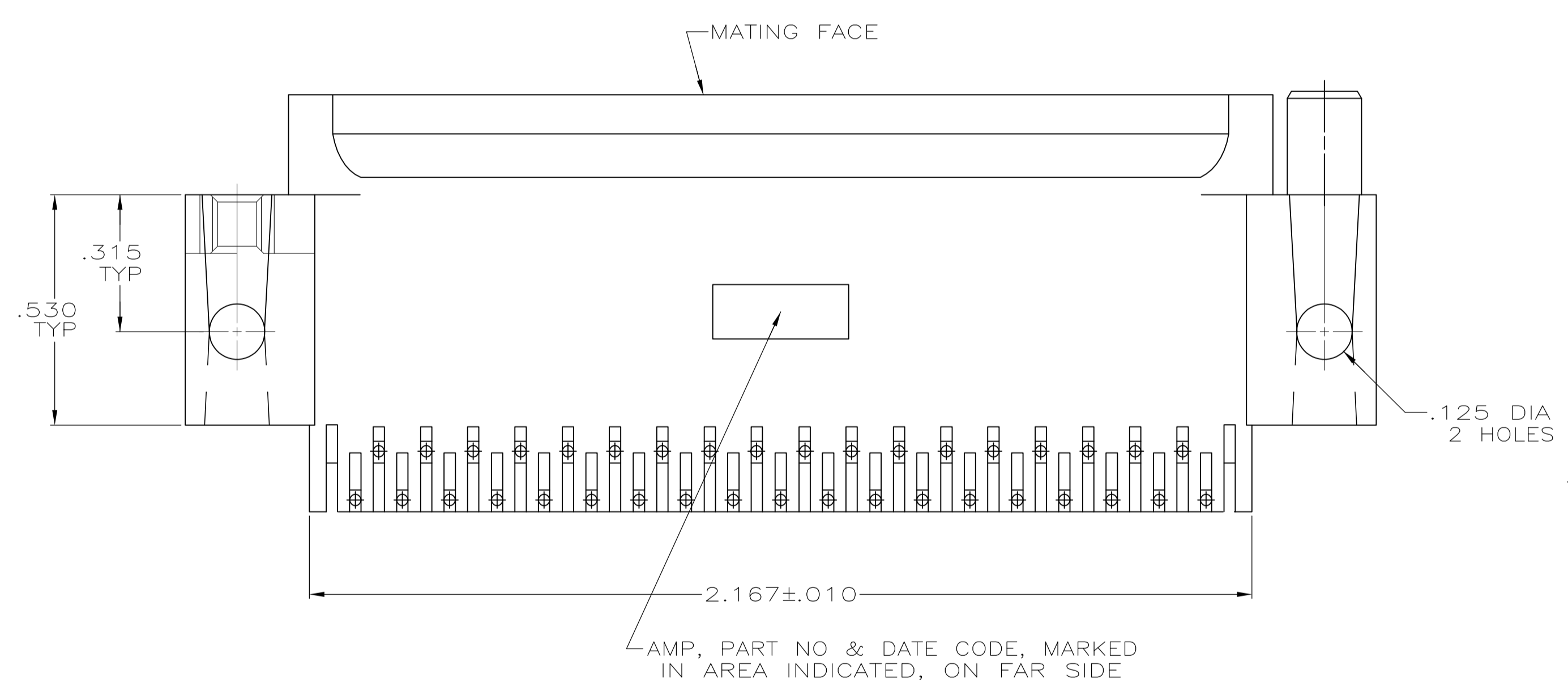

RECOMMENDED P.C. BOARD MOUNTING DIMENSIONS 3

OBSELETE	WITH SCREWLOCKS	5	747470 -6
OBSELETE	WITH SCREWLOCKS	4	747470 -5
OBSELETE	WITH INSERTS	5	747470 -4
OBSELETE	WITH INSERTS	4	747470 -3
	WITH $.120$ DIA HOLE	5	747470 -2
SUPSD BY 747470-2	WITH $.120$ DIA HOLE	4	747470 -1
	REMARKS	FINISH	PART NUMBER

THIS DRAWING IS A CONTROLLED DOCUMENT.		DIN C RICHARD 7-29-87	TE Connectivity	
DIMENSIONS: INCHES		CHK S WELDON 8-3-87	NAME	
TOLERANCES UNLESS OTHERWISE SPECIFIED:		APVD B TAYLOR 8-3-87	PRODUCT SPEC	
0 PLC ± -		108-40005		
1 PLC ± -		APPLICATION SPEC		
2 PLC ± -		114-40015		
3 PLC ± .005		SIZE		
4 PLC ± -		114-40015		
ANGLES ± ± °		WEIGHT		
MATERIAL		A1 00779 C=747470		
FINISH		CUSTOMER DRAWING		
SCALE 4:1		SHEET 1 OF 1		