

MATERIAL NUMBER	ENGINEERING NUMBER	CARRIER	FINISH
190160111	BB-1141	LOOSE	TIN PLATING
190160063	BBZ-1141	STRIP	TIN PLATING
190160126	BB-1141-N	LOOSE	NICKEL PLATING

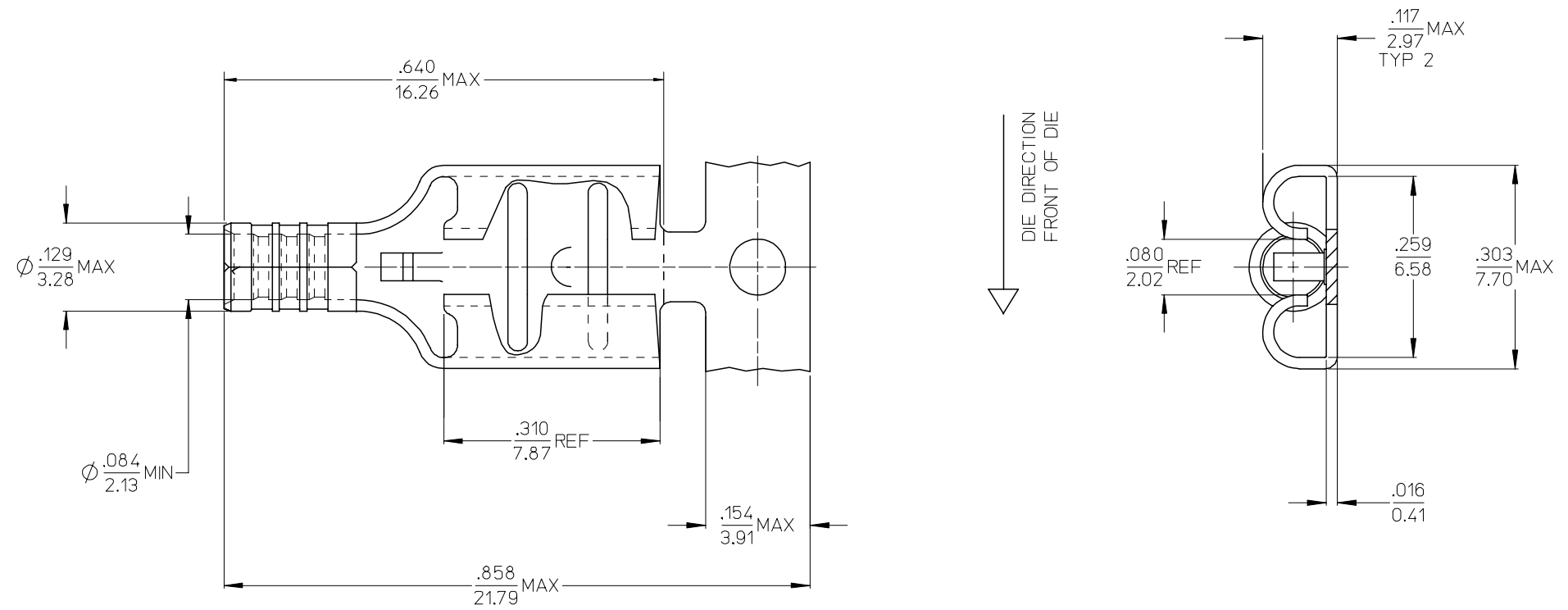

- NOTES:
- ENTIRE PART TO BE FREE OF BURRS AND SHARP EDGES
 - LOOSE PIECE PARTS TO HAVE CUT-OFF TAB .005-.020
 - MATERIAL: 3/4 HARD BRASS

RELEASED EC NO: ETC2006-0143 DRWN:NASYDEH 2005/12/17 CHKD:RDEROSS 2005/12/19 APPR:RDEROSS 2005/12/14	DESCRIPTION A	QUALITY SYMBOLS	GENERAL TOLERANCES (UNLESS SPECIFIED)	DIMENSION STYLE	SCALE	DESIGN UNITS	THIRD ANGLE PROJECTION															
		$\nabla=0$ $\nabla=0$	<table border="1"> <thead> <tr> <th></th> <th>mm</th> <th>INCH</th> </tr> </thead> <tbody> <tr> <td>4 PLACES</td> <td>± ---</td> <td>± ---</td> </tr> <tr> <td>3 PLACES</td> <td>± ---</td> <td>± .010</td> </tr> <tr> <td>2 PLACES</td> <td>± 0.25</td> <td>± .02</td> </tr> <tr> <td>1 PLACE</td> <td>± 0.3</td> <td>± ---</td> </tr> </tbody> </table>		mm	INCH	4 PLACES	± ---	± ---	3 PLACES	± ---	± .010	2 PLACES	± 0.25	± .02	1 PLACE	± 0.3	± ---	IN/MM	4:1	INCH	
			mm	INCH																		
		4 PLACES	± ---	± ---																		
3 PLACES	± ---	± .010																				
2 PLACES	± 0.25	± .02																				
1 PLACE	± 0.3	± ---																				
		<table border="1"> <thead> <tr> <th>DRAWN BY</th> <th>DATE</th> </tr> </thead> <tbody> <tr> <td>JLOMASTRO</td> <td>05/12/07</td> </tr> <tr> <th>CHECKED BY</th> <th>DATE</th> </tr> <tr> <td>RDEROSS</td> <td>05/12/07</td> </tr> <tr> <th>APPROVED BY</th> <th>DATE</th> </tr> <tr> <td>RDEROSS</td> <td>05/12/07</td> </tr> </tbody> </table>	DRAWN BY	DATE	JLOMASTRO	05/12/07	CHECKED BY	DATE	RDEROSS	05/12/07	APPROVED BY	DATE	RDEROSS	05/12/07	TITLE	QUICK CONNECT RECEPTACLE FOR 16-14 AWG .250X.032 TAB SIZE						
DRAWN BY	DATE																					
JLOMASTRO	05/12/07																					
CHECKED BY	DATE																					
RDEROSS	05/12/07																					
APPROVED BY	DATE																					
RDEROSS	05/12/07																					
		DRAFT WHERE APPLICABLE MUST REMAIN WITHIN DIMENSIONS	MATERIAL NO. SEE CHART	DOCUMENT NO. SD-19016-003	MOLEX INCORPORATED																	