

4		3		2		1	
ITEM	CONNECTOR PART NO.	DESCRIPTION	IPI CHECK	EOR CHECK	Applicable Tooling		
1	SPHD-001T-P0.5	CONTACT FOR PA & PBV			APPLICATOR		
2	UL1061, 22 AWG	BLACK			Applicable Housings		

NO. OF POS.	PA SERIES HOUSING PART NOS.	PBV SERIES HOUSING PART NOS.
2	PAP-02V-S	
3	PAP-03V-S	PBVP-03V-S
4	PAP-04V-S	PBVP-04V-S
5	PAP-05V-S	
6	PAP-06V-S	PBVP-06V-S
7	PAP-07V-S	
8	PAP-08V-S	PBVP-08V-S
9	PAP-09V-S	
10	PAP-10V-S	PBVP-10V-S
11	PAP-11V-S	
12	PAP-12V-S	PBVP-12V-S
13	PAP-13V-S	
14	PAP-14V-S	
15	PAP-15V-S	PBVP-15V-S
16	PAP-16V-S	

D

D

C

C

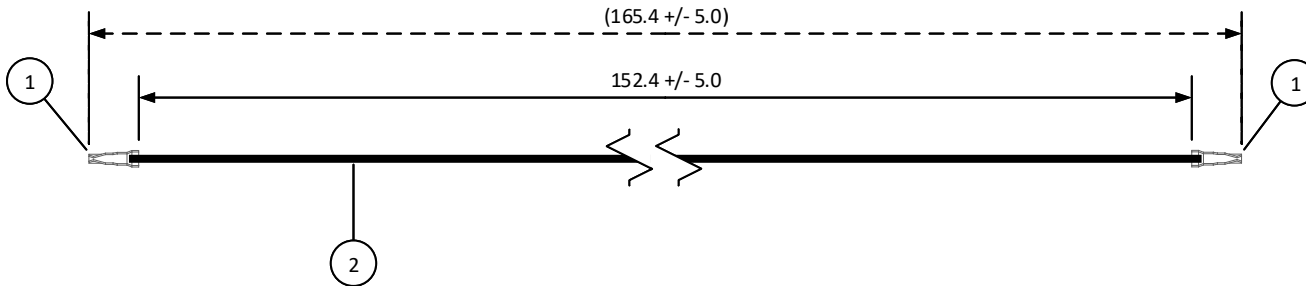

B

B

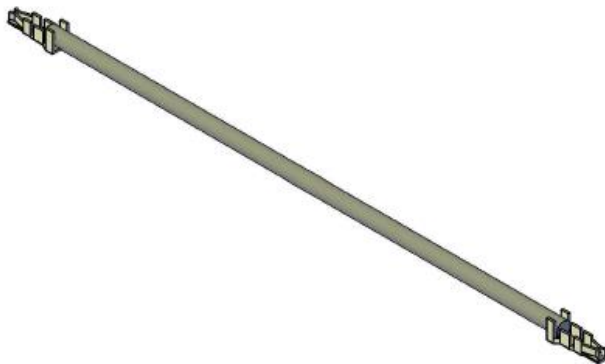

JST

A

A

SCALE	CUSTOMER NAME	CUSTOMER PART NO.
1:1		
DIMENSIONS All dimensions are in MM with a tolerance of +/- 3.0 unless otherwise specified.	DESCRIPTION 2.0 mm Pitch PA & PBV Series Standard Leads - 6" Inside Length DOUBLE-END LEADS, F-F	
DRAWN BY STEVEN PILKINGTON	ASSEMBLY PART NO. APAPA22K152	
CHECKED BY JUSTIN BAKER	DRAWING NO. & REVISION GAM-062	DATE 3/8/2016

1	Incorporate the PBV series housings	3/23/2017	SP
REV.	DESCRIPTION	DATE	BY

4

3

2

1