

1 2 3 4 5 6

A

B

C

D

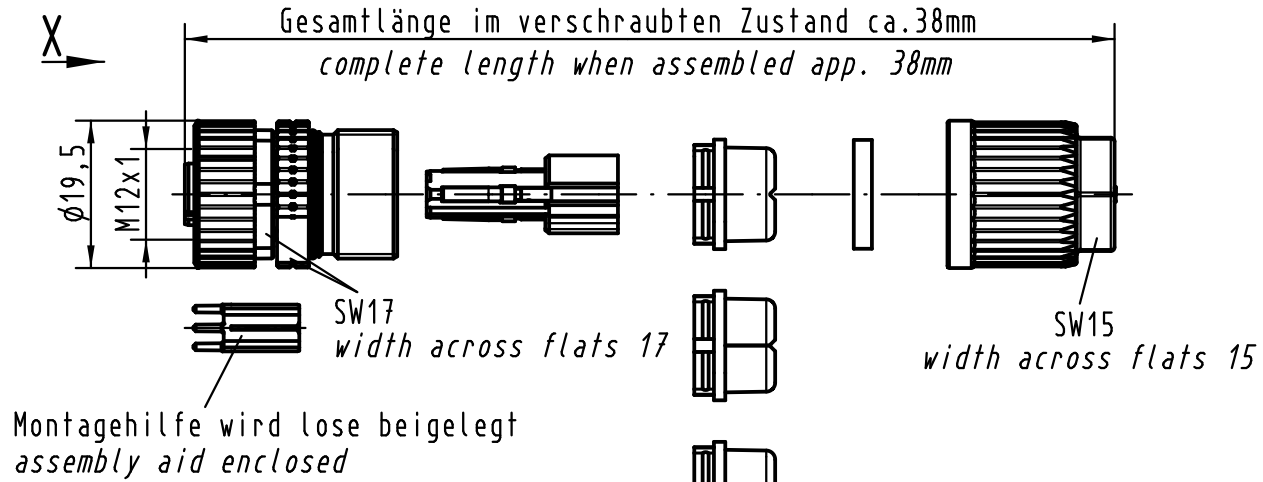

X (2:1)

Steckgesicht n.
Contact face acc.to
IEC 61076-2-101

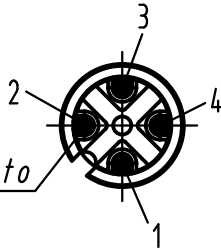

Crimpkontakte separat bestellen
Order contacts separately

Kabelø / Cableø			Leiterquerschnitt Wire gauge	Bestell-Nr. Part-No.
5,5-7,2mm	4,5-5,4mm	7.0-8.8mm		
Dichtung / Sealing			AWG 26-22	09 67 000 5476
schwarz / black	transparent	beige	AWG 24-20	09 67 000 8476

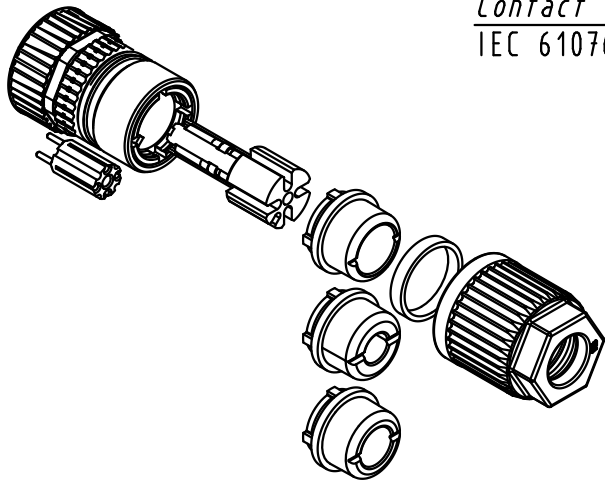

All Dimensions in mm Original Size DIN A 4			Techn. Character.			Nicht tolerierte Maß / Free size tolerances			
EC04038	10.11.11	DY	Dat.	Name	Maßstab / Scale 1:1	M12-L RSV geschirmt crimp, Buchse, 4-polig, A-kodiert Circular connector shielded crimp, female, 4-pole, A-coded			
EC03243	20.05.11	DY	Detail.	06.03.07					HO
EC02599	22.02.11	DY	Insp.						SUN
EC01106	23.11.09	DY	Stand.						
414313	13.02.09	DY	HARTING Electronics GmbH & Co. KG			TB 21 03 812 2405			
Mod.	Dat.	Name	D-32339 ESPELKAMP						Blatt / page Sub.

