

LOC	DIST	REVISIONS					
		P	LTN	DESCRIPTION	DATE	DWN	APVD
		1		PROPOSED DESIGN	28JUN06	CZ	SY
		A1		REV PER ECR-06-020307	24JUG2006	CZ	SY
		A2		REV PER ECR-13-004638	20MAR2013	ML	SZ

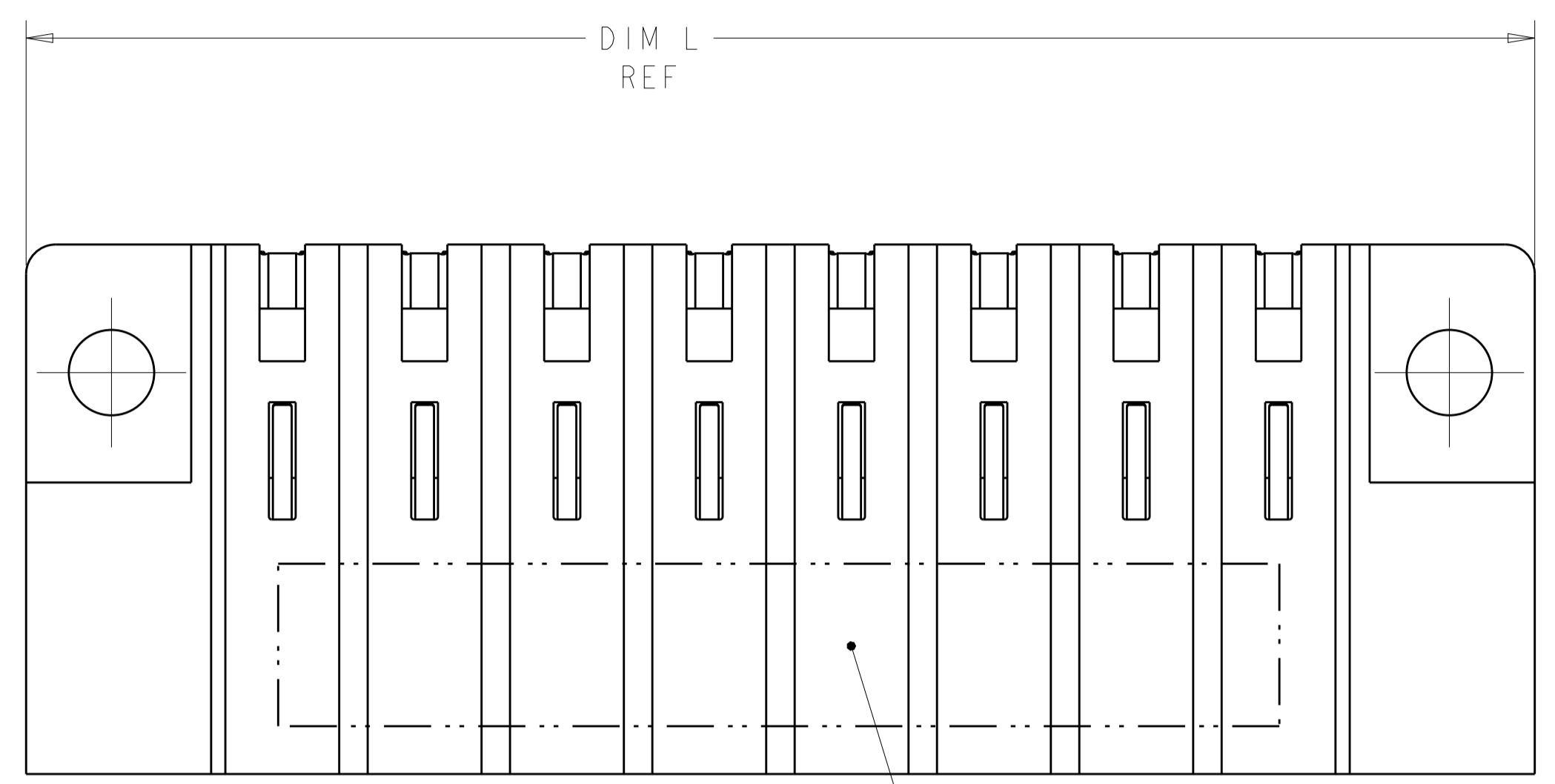

- 1 "AMP", PART NUMBER, AND DATE CODE TO BE MARKED IN AREA SHOWN. PARTS UNDER 2.00 LONG MAY BE MARKED ON BOTH SIDES.
- 2 MATERIAL: HOUSING - GLASS FILLED HIGH TEMP THERMO PLASTIC, UL94 V-0  
POWER CONTACT - HIGH CONDUCTIVITY COPPER ALLOY
- 3 CONTACT PLATING: NOBLE METAL PLATING ON CONTACT FUNCTIONAL AREA OF POWER AND SIGNAL CONTACTS
- 4 MECHANICAL CONNECTOR KEEP OUT ZONE.
- 5 DATUM AND BASIC DIMENSIONS ESTABLISHED BY CUSTOMER.
- 6 PCB - ALL HOLE DIAMETERS ARE FINISHED HOLE SIZES.
- 7 PCB - .0453 +/- .0010 DRILLED HOLES PLATES WITH .0003 MIN Sn OVER .001 TO .003 PLATING TO ACHIEVE A .040 DIA. HOLE.
- 8 VARIABLE DIMENSION SHOW ON VIEW (SHEET 2).
- 9 NOT RELEASE FOR PRODUCTION.

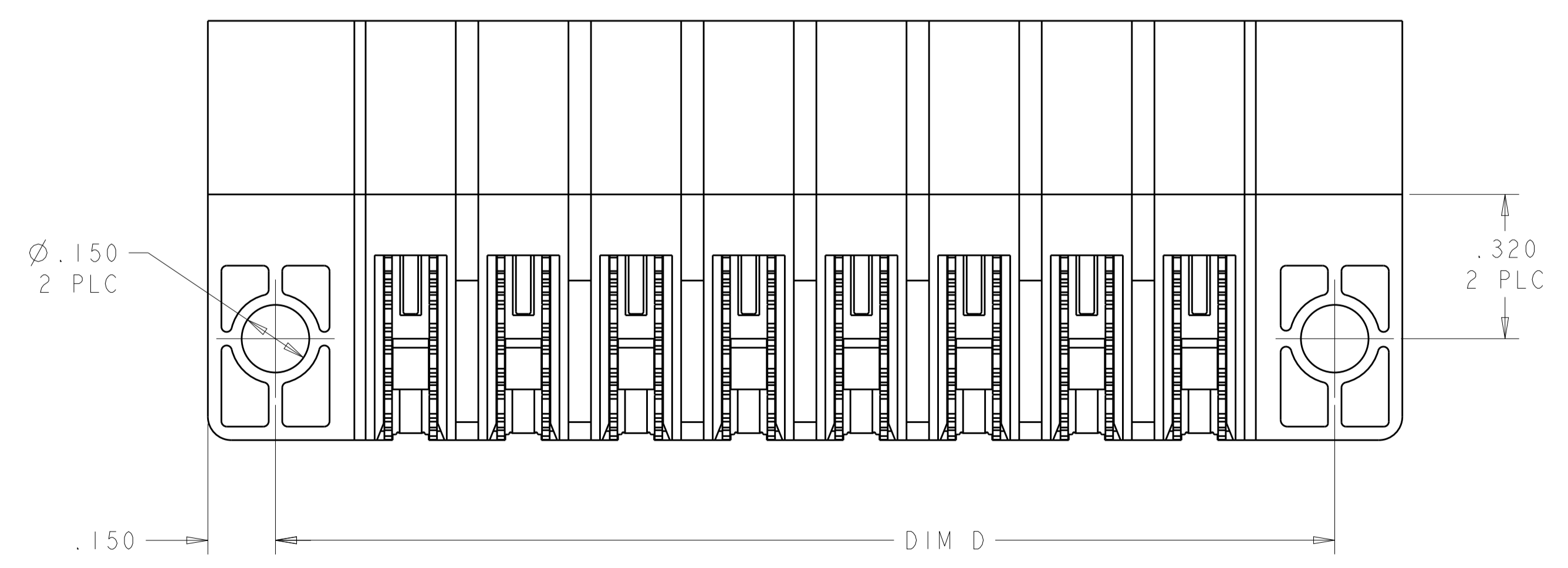
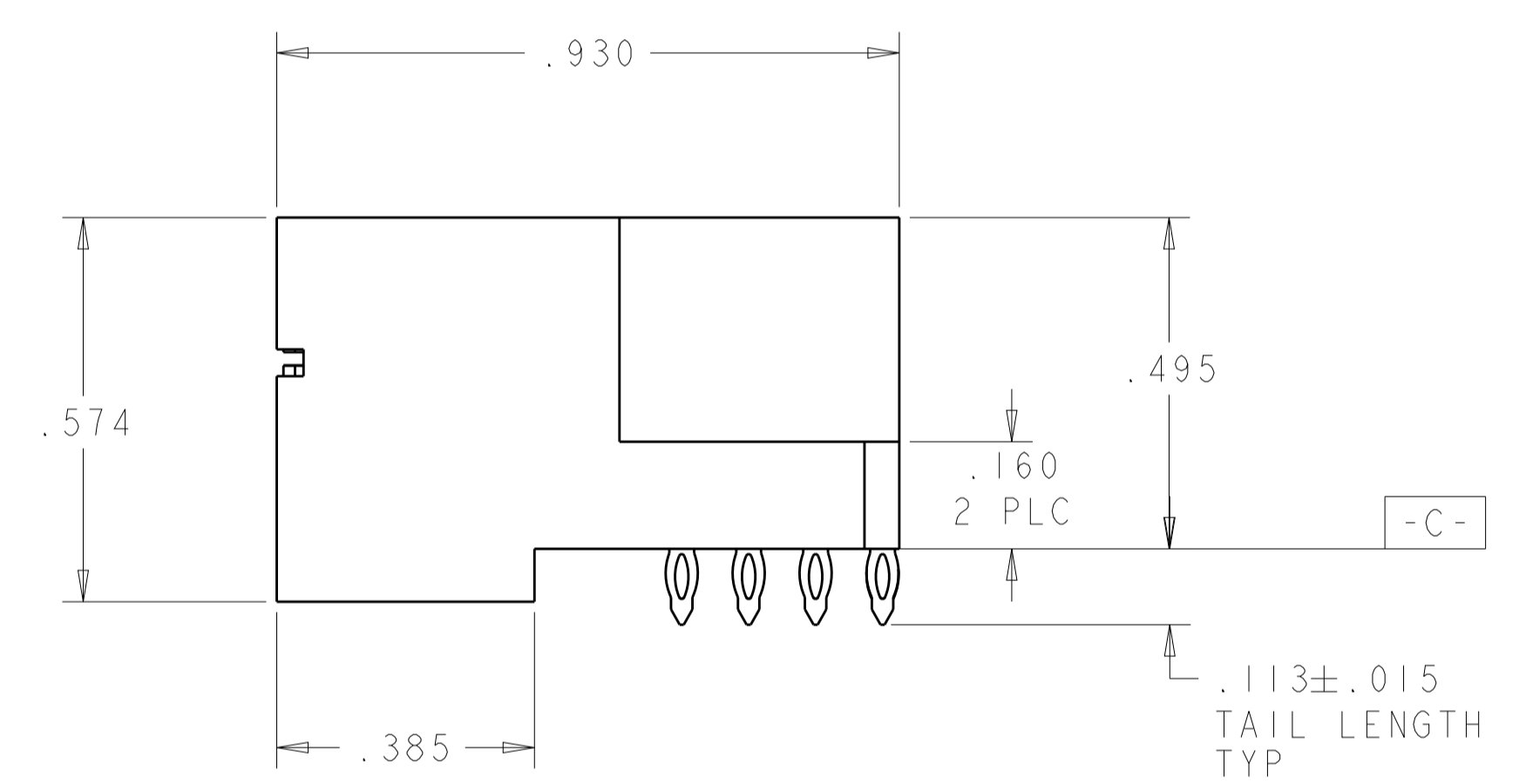
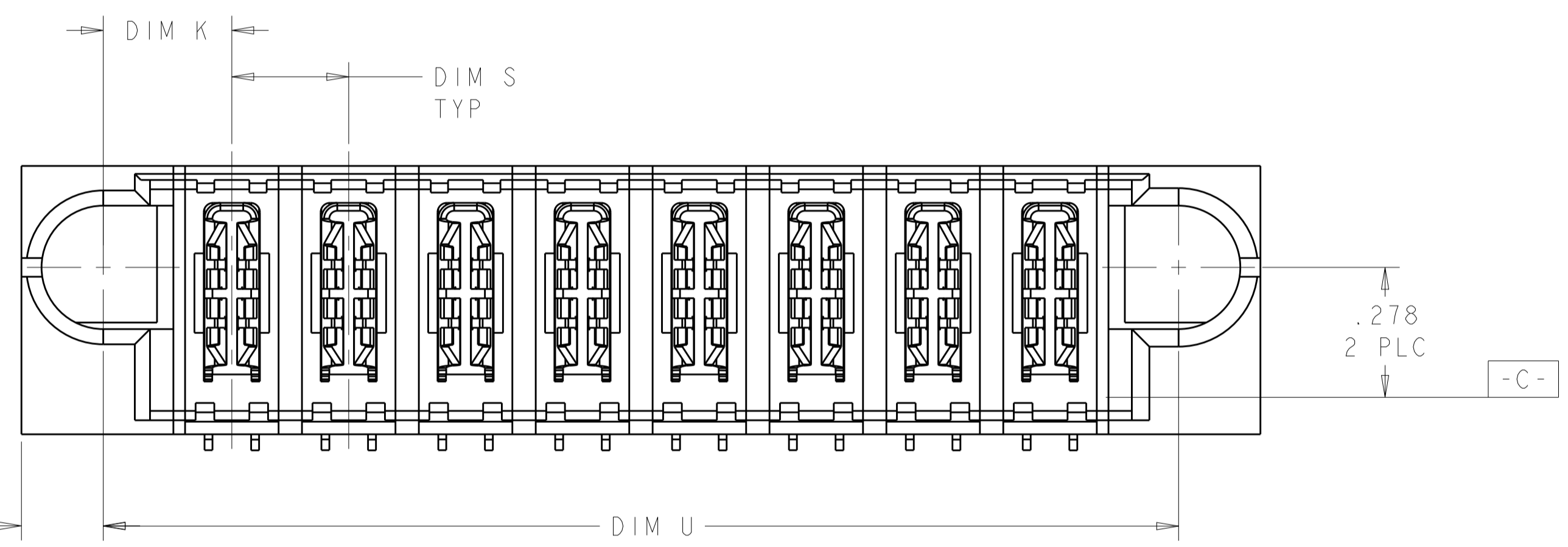

△	.250	2.550	2.600	.450	2.900	9P	6450623-3
△	.250	1.700	1.750	.425	2.050	6P	6450623-2
	.250	2.300	2.350	.450	2.650	8P	6450623-1
	DIM S	DIM U	DIM D	DIM K	DIM L	DESCRIPTION	PART NUMBER

DIMENSIONS: INCHES 		TOLERANCES UNLESS OTHERWISE SPECIFIED: 0 PLC ±. 1 PLC ±.01 2 PLC ±.005 3 PLC ±.0020 4 PLC ±.0020 ANGLES ±.7°		DWN: CECILY.ZHOU 28JUN06 CHK: S.ZHAO 28JUN06 APVD: S.YAO NAME: RIGHT ANGLE HEADER ASSEMBLY W/GUIDES PRESS FIT, .150 MOUNTING HOLES MULTI-BEAM XL PRODUCT SPEC: 108-1973 APPLICATION SPEC: 114-13038 WEIGHT: - Customer Drawing		Tyco Electronics incorporated Shanghai, P.R.China. 200233	
MATERIAL: - FINISH: -		SCALE: 2:1 SHEET: 1 OF 2 REV: A2		SIZE: A CAGE CODE: 6450623 DRAWING NO: 100779		RESTRICTED TO: -	

LOC	DIST	REVISIONS			
P	LTN	DESCRIPTION	DATE	DWN	APVD
-	-	SEE SHEET 1	-	-	-

PART NUMBER	POWER							
	P1	P2	P3	P4	P5	P6	P7	P8
6450623-1	PT	PT	PT	PT	PT	PT	PT	PT
8P								

PART NUMBER	POWER					
	P1	P2	P3	P4	P5	P6
6450623-2	PT	PT	PT	PT	PT	PT
6P						

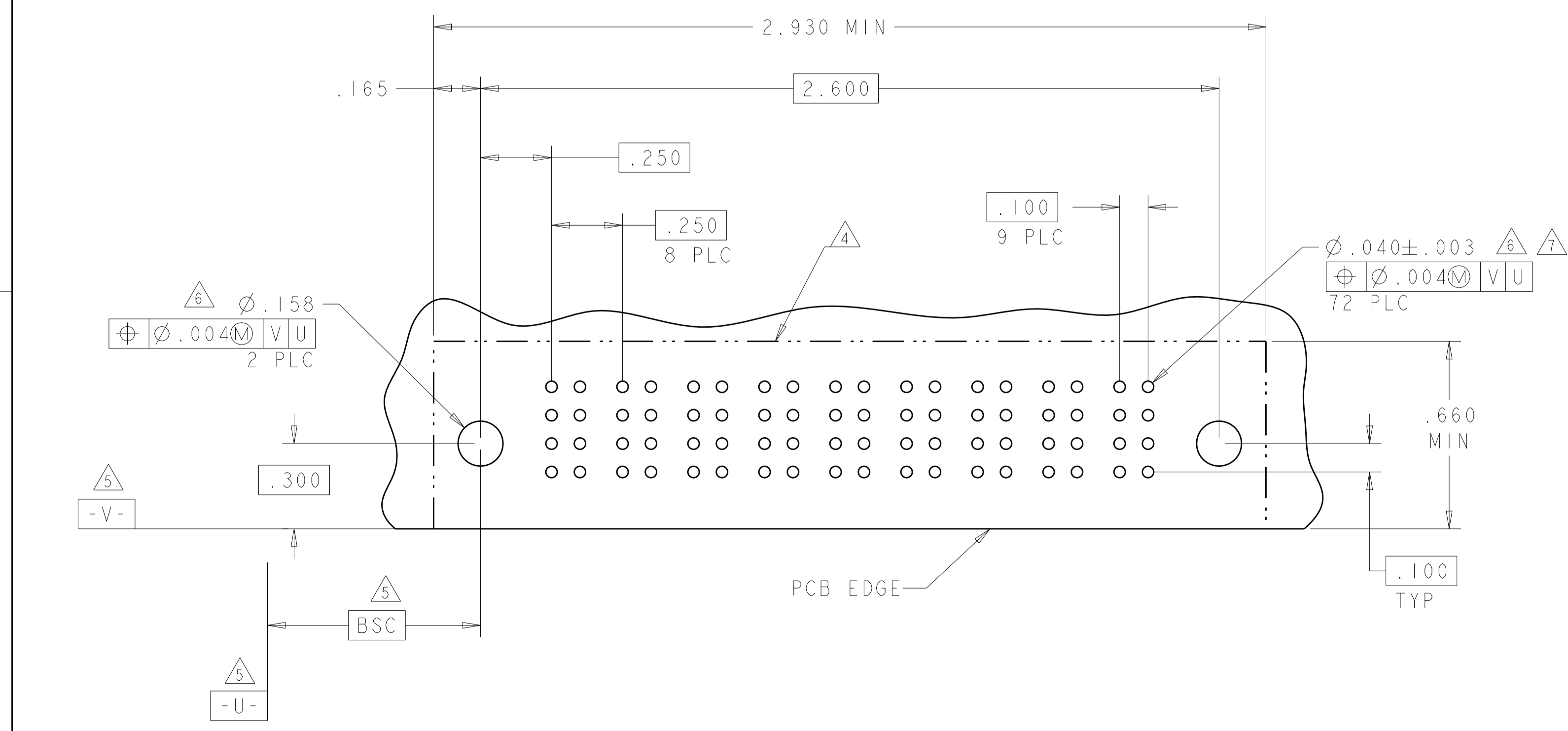
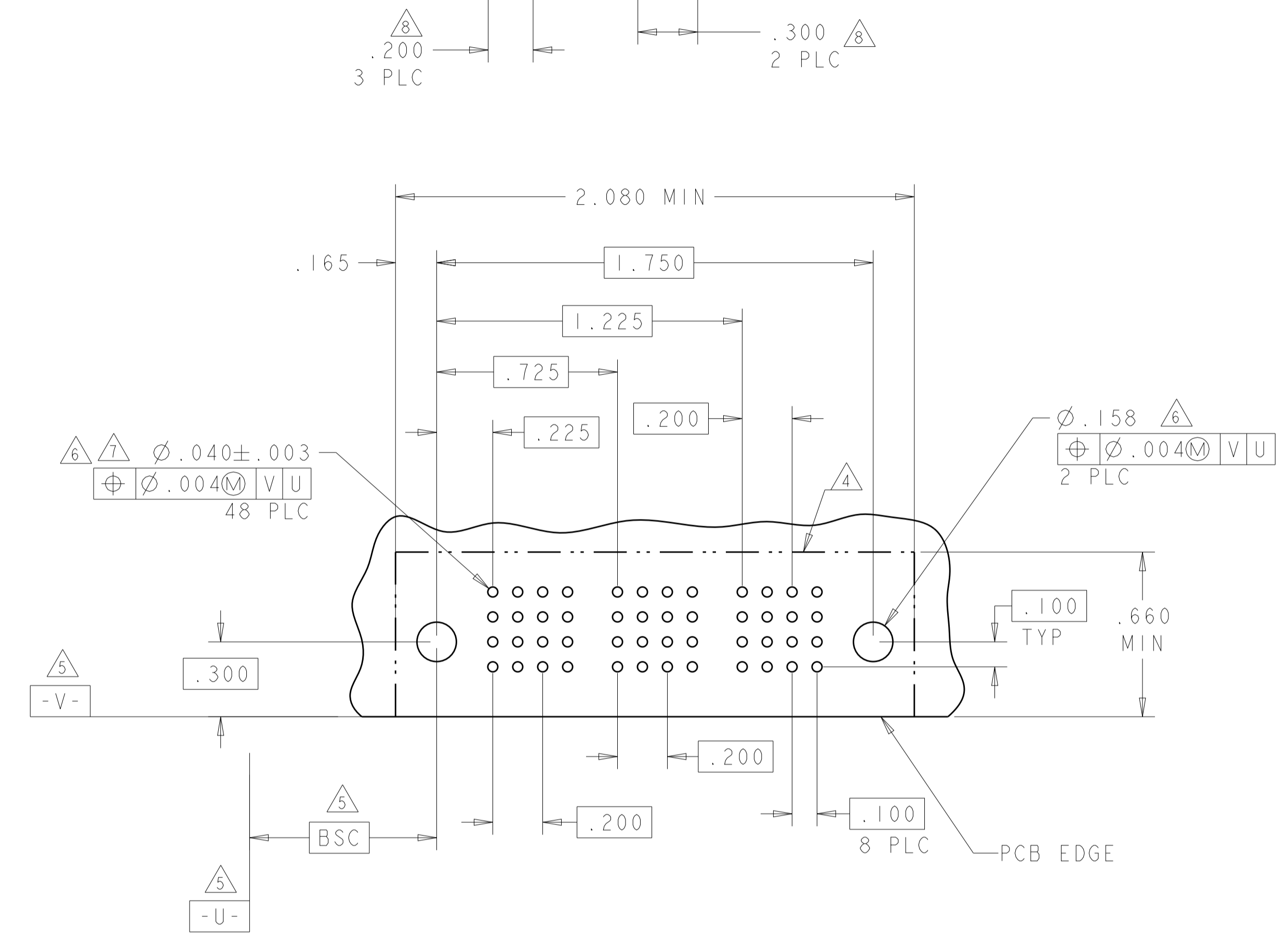
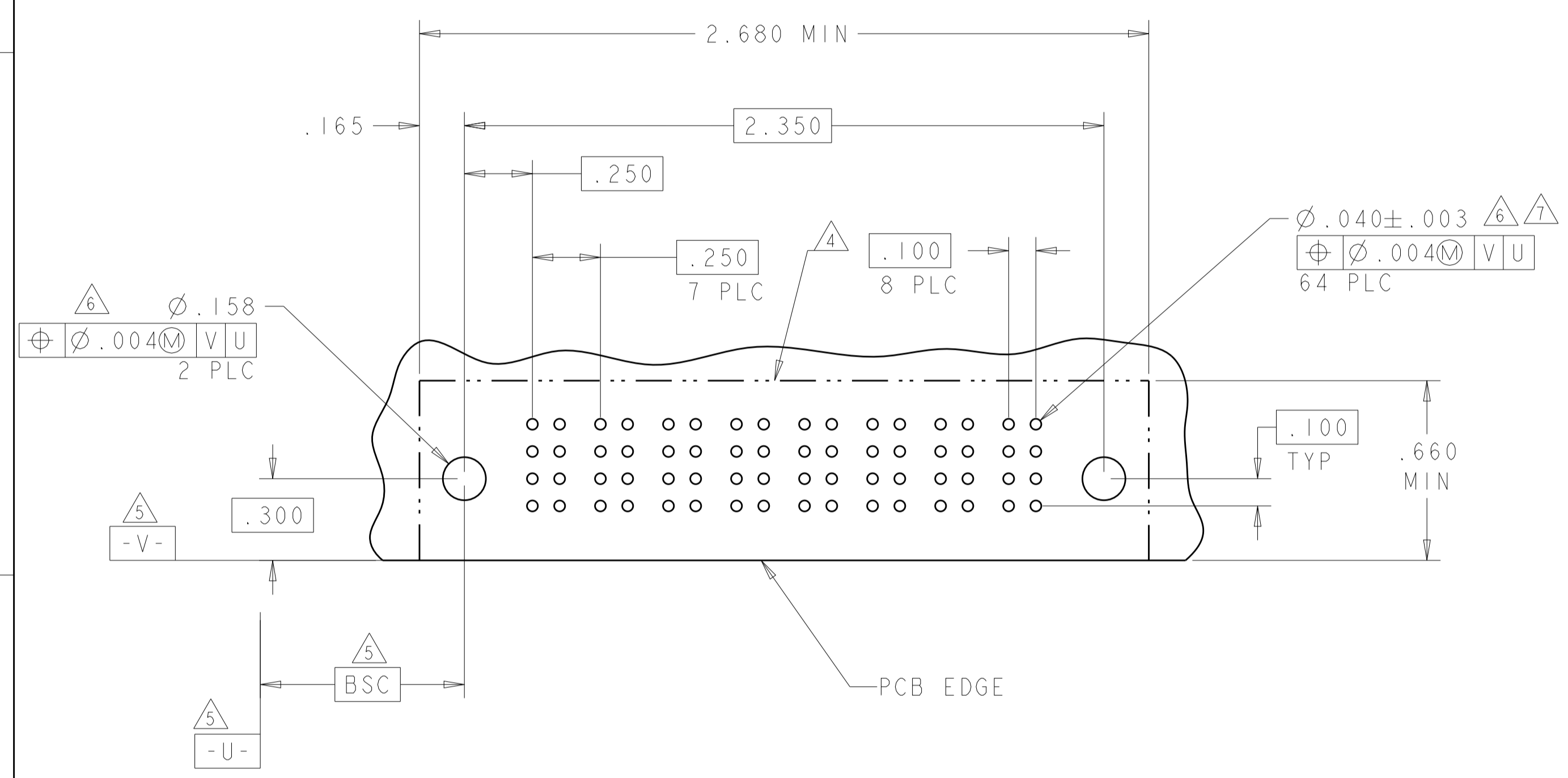

PART NUMBER	POWER								
	P1	P2	P3	P4	P5	P6	P7	P8	P9
6450623-3	PT	PT	PT	PT	PT	PT	PT	PT	PT
9P									

POWER CONTACT, STD	PT
DESCRIPTION	CODE

DIMENSIONS: INCHES 		TOLERANCES UNLESS OTHERWISE SPECIFIED: 0 PLC ±. 1 PLC ±.01 2 PLC ±.01 3 PLC ±.005 4 PLC ±.0020 ANGLES ±.7°		DWN: G. CECILY, ZHOU 28JUN06 CHK: S. ZHAO 28JUN06 APVD: S. YAO PRODUCT SPEC: 108-1973 APPLICATION SPEC: 114-13038 WEIGHT: - Customer Drawing		NAME: S. YAO Tyco Electronics incorporated Shanghai, P.R. China. 200233	
MATERIAL: - FINISH: -		SIZE: 114-13038 CAGE CODE: - DRAWING NO: 6450623		RESTRICTED TO: - SCALE: 2:1 SHEET: 2 OF 2 REV: A2		NAME: S. YAO Tyco Electronics incorporated Shanghai, P.R. China. 200233	