

# CRD Series 10mm DIP Coded Rotary Switches

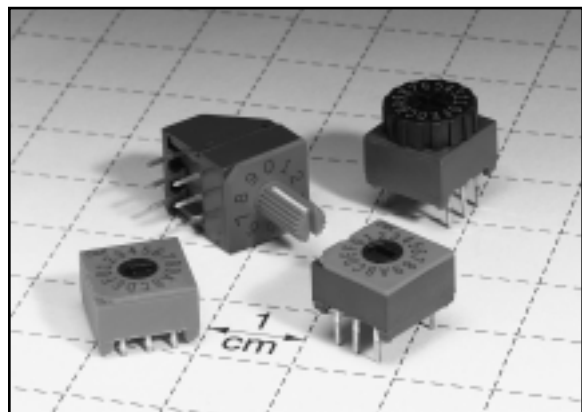

## Features/Benefits

- **Process sealed** – withstands soldering and cleaning
- **Thru-hole and surface mount models**
- **Crisp, positive detent ensures actuation**

## Typical Applications

- **Address switching applications**
- **Data storage devices**
- **Computer and peripherals**
- **Instrumentation**

## How To Order

Our easy Build-A Switch concept allows you to mix and match options to create the switch you need. Below is a complete listing of options shown in catalog. To order, simply select desired option from each category and place in the appropriate box. Switches with standard options are show on page D-17. Available options are shown and described on pages D-18 and D-19. For additional options not shown in catalog, consult Customer Service Center.

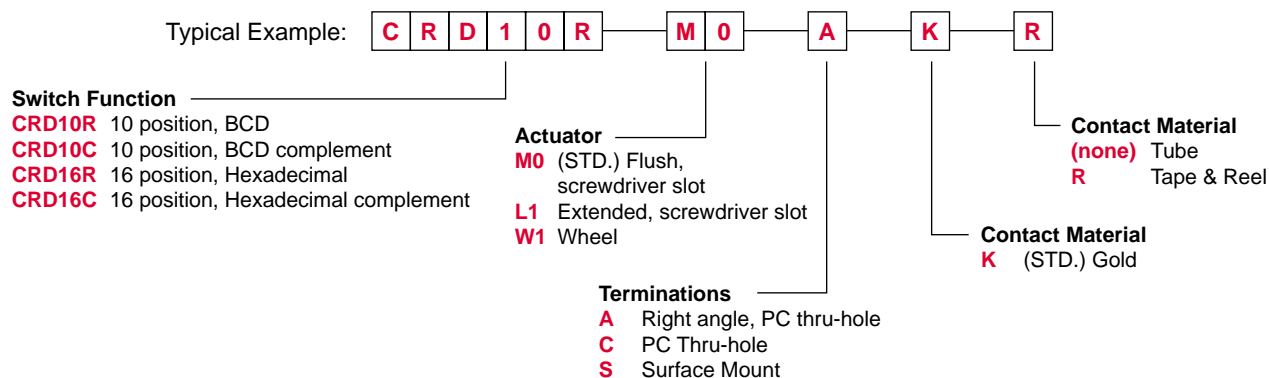

DIP

## Specifications

CONTACT RATING: 0.4 V AC, DC 20 V max.  
 ELECTRICAL LIFE: 20,000 steps min. @ 5 V DC 10 mA.  
 MECHANICAL LIFE: 30,000 steps min.  
 CONTACT RESISTANCE: 100 milliohms max. initial @ 2 V DC 10 mA.  
 INSULATION RESISTANCE: 1000 megohms min. @ 100 V DC  
 DIELECTRIC STRENGTH: 300 V AC for 1 minute.  
 OPERATING TEMPERATURE: -20°C to 85°C.  
 STORAGE TEMPERATURE: -40°C to 85°C.  
 OPERATING FORCE: 1000 grams max.  
 PACKAGING: Anti-static tube or tape & reel, 500 pieces per reel.

## Materials

COVER: (PTH) PBT red; (SMT) PPA - red (UL 94V-0).  
 HOUSING: (PTH) PBT green; (SMT) PPA - red (UL 94V-0).  
 ACTUATOR: 4/6 nylon PA-6T (UL 94V-0).  
 CONTACTS: Beryllium copper with gold over nickel.  
 TERMINALS: Brass with tin-lead plated.

**NOTE:** Specifications and materials listed above are for switches with standard options. For information on specific and custom switches, consult Customer Service Center.

## SWITCHES WITH STANDARD OPTIONS

### PC Mount

PART NUMBER	NO. POS.	QUANTITY PER TUBE
<b>CRD10RM0CK</b>	10	45
<b>CRD16RM0CK</b>	16	45

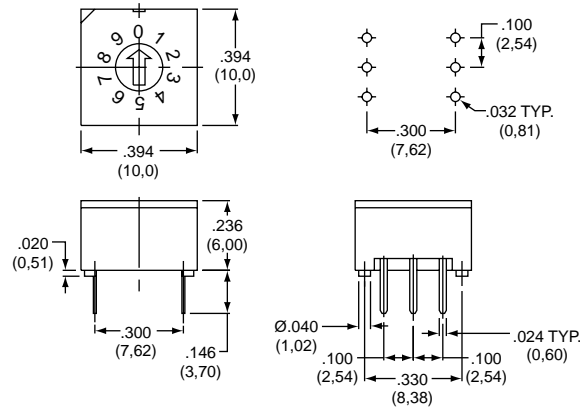

CRD10RM0CK

### Right Angle Mount

PART NUMBER	NO. POS.	QUANTITY PER TUBE
<b>CRD10RM0AK</b>	10	45
<b>CRD16RM0AK</b>	16	45

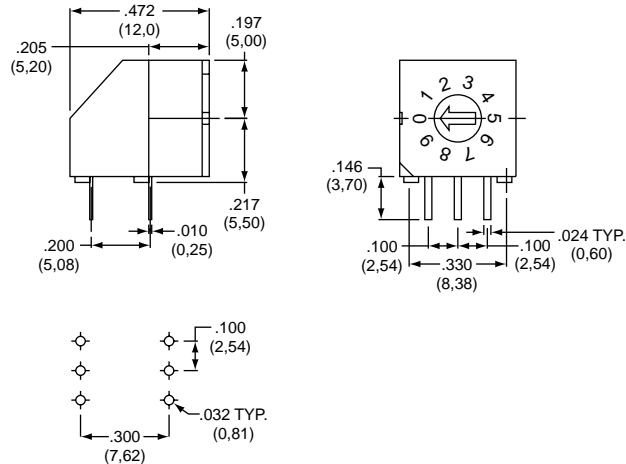

CD10RM0AK

### Surface Mount

PART NUMBER	NO. POS.	QUANTITY PER TUBE
<b>CRD10RM0SK</b>	10	45
<b>CRD16RM0SK</b>	16	45

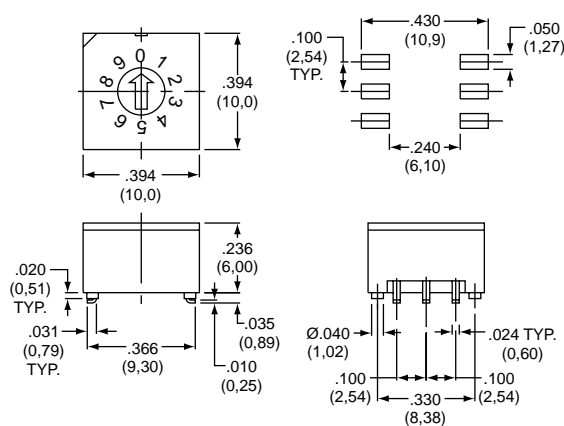

CD10RM0SK



DIP

# CRD Series 10mm DIP Coded Rotary Switches



## SWITCH FUNCTION

**CRD10R** 10 POSITION, BCD  
ACTUATOR COLOR: WHITE

**CRD10C** 10 POSITION, BCD COMPLEMENT  
ACTUATOR COLOR: BLACK

POS.	0	1	2	3	4	5	6	7	8	9
C	●	●	●	●	●	●	●	●	●	●
1		●		●		●		●		●
2			●	●			●	●		
4					●	●	●	●		
8									●	●

POS.	0	1	2	3	4	5	6	7	8	9
C	●	●	●	●	●	●	●	●	●	●
1	●		●		●		●		●	
2	●	●			●	●			●	●
4	●	●	●	●				●	●	●
8	●	●	●	●	●	●	●	●	●	●

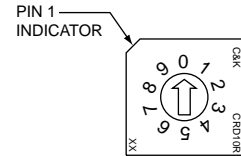

**CRD16R** 16 POSITION, HEXADECIMAL  
ACTUATOR COLOR: WHITE

**CRD16C** 16 POSITION, HEXADECIMAL COMPLEMENT  
ACTUATOR COLOR: BLACK

POS.	0	1	2	3	4	5	6	7	8	9	A	B	C	D	E	F
C	●	●	●	●	●	●	●	●	●	●	●	●	●	●	●	●
1		●		●		●		●		●		●		●		●
2			●	●			●	●			●	●			●	●
4					●	●	●	●				●	●	●	●	
8									●	●	●	●	●	●	●	●

POS.	0	1	2	3	4	5	6	7	8	9	A	B	C	D	E	F
C	●	●	●	●	●	●	●	●	●	●	●	●	●	●	●	●
1	●		●		●		●		●		●		●		●	
2	●	●			●	●			●	●			●	●		
4	●	●	●	●					●	●	●	●				
8	●	●	●	●	●	●	●	●	●	●	●	●	●	●	●	●

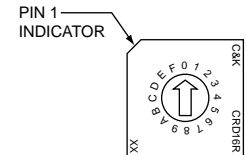

DIP

## ACTUATOR

**M0** (STD.) FLUSH WITH SCREWDRIVER SLOT

**L1** EXTENDED WITH SCREWDRIVER SLOT

**W1** WHEEL

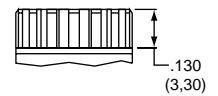
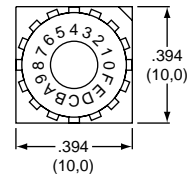
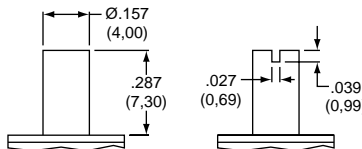
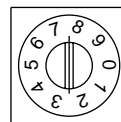
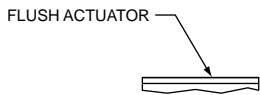
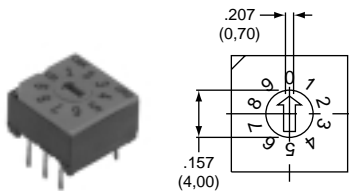

NOTE: Designed for #0 Phillips screwdriver.

## TERMINATIONS

### C PC THRU-HOLE

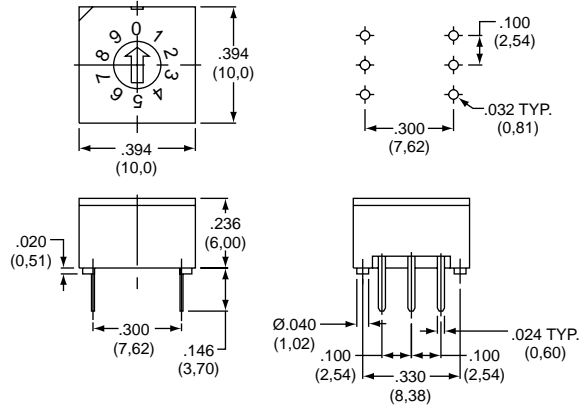

### A RIGHT ANGLE, PC THRU-HOLE

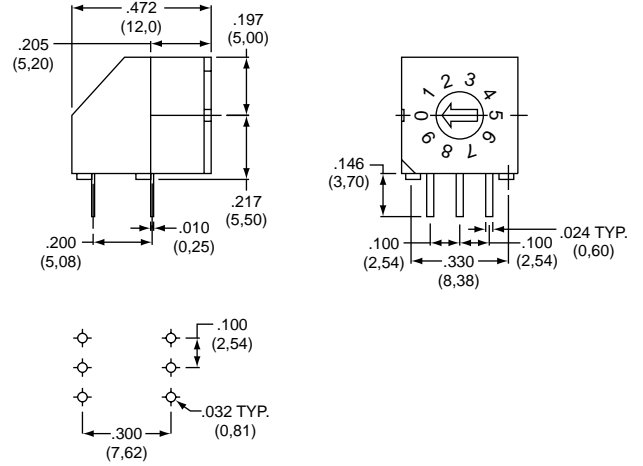

### S SURFACE MOUNT

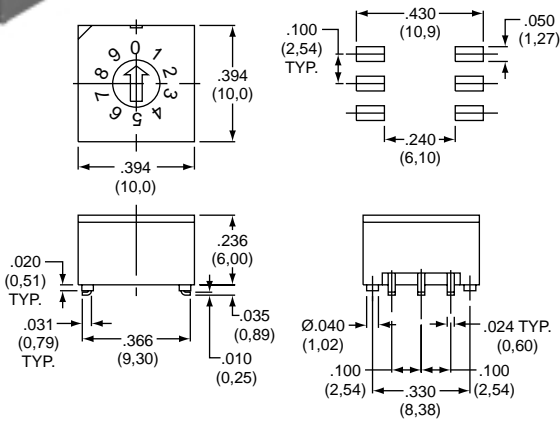

DIP

## CONTACT MATERIAL

OPTION CODE	CONTACT MATERIAL	TERMINAL PLATING	RATING
<b>K (STD.)</b>	GOLD	TIN-LEAD	LOW LEVEL/DRY CIRCUIT 0.4 VC MAX. @ 20 V AC or DC MAX.