

REVISIONS					
P	LTR	DESCRIPTION	DATE	DWN	APVD
C3	REVISED	ECR-16-003280	06SEP2016	KF	HY

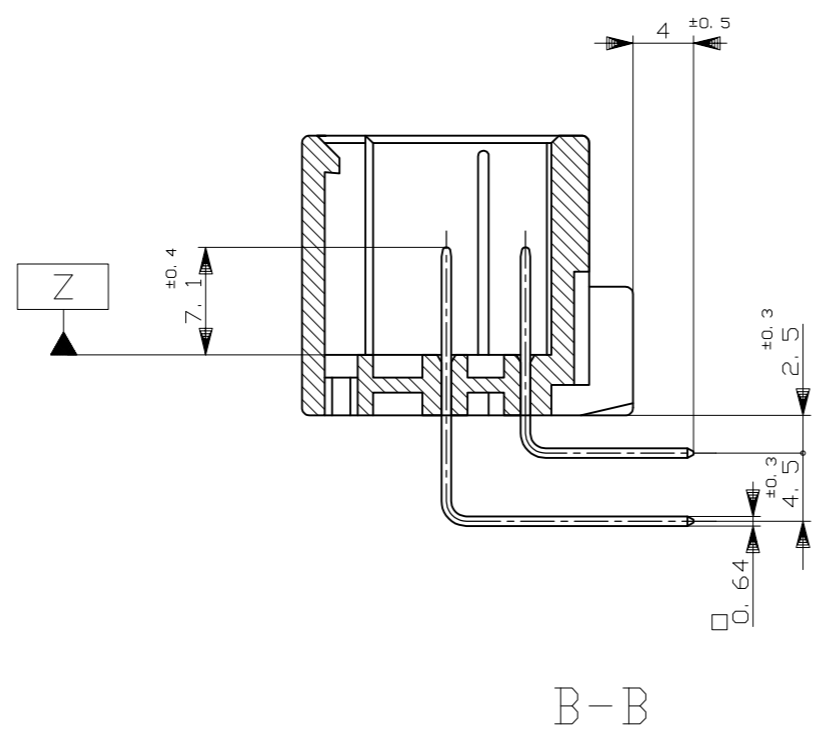

- ① Z面から2mmの範囲で測定
- 2. 嵌合相手ハウジング型: 175567, 917994
- 3. 推奨取付ねじ: JIS B1115, B1122 タッピングねじ, なべ2種  
呼び径3, 長さ6mm以下 (締付けトルク: 0.4N-m (4kg-cm) 以下)
- 4. 適用製品規格番号: 108-5280, 108-5342
- ⑤ 回路番号: 右図参照のこと  
パワー回路 ①~⑩  
シグナル回路 ⑪~⑳
- ⑥ 適用製品型番のプリフィックス及びIDマークを  
カラーホットマークにて表示

- ① MUST BE KEPT BETWEEN Z AND 2
- 2. THE MATING PLUG HSG.PART NUMBER: 175567, 917994
- 3. RECOMMENDED MOUNTING SCREW; 3mm DIA, 6mm LENGTH (MAX.)  
PAN HEAD, CLASS 2 TAPPING SCREW SPECIFIED IN JIS  
B1115, B1122  
(TIGHTENING TORQUE; 0.4N-m (4Kg-cm) MAX)
- 4. APPLICABLE PRODUCT SPEC NO.: 108-5280, 108-5342
- ⑤ CIRCUIT NUMBER  
POWER CIRCUIT NO. ① ~ ⑩  
SIGNAL CIRCUIT NO. ⑪ ~ ⑳
- ⑥ INDICATED PREFIX AND ID MARK OF PRODUCT P/N BY HOT MARK

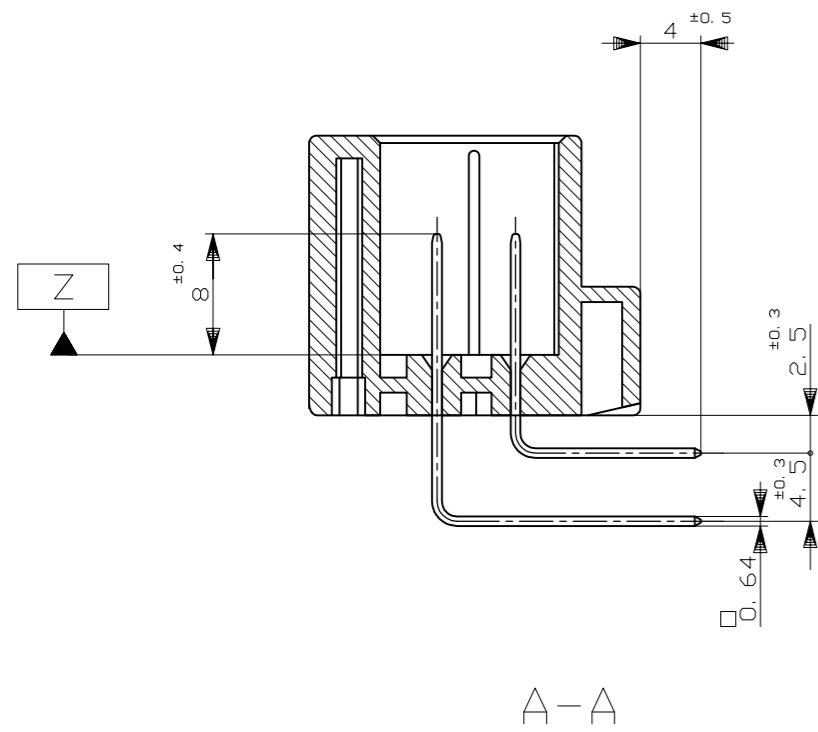
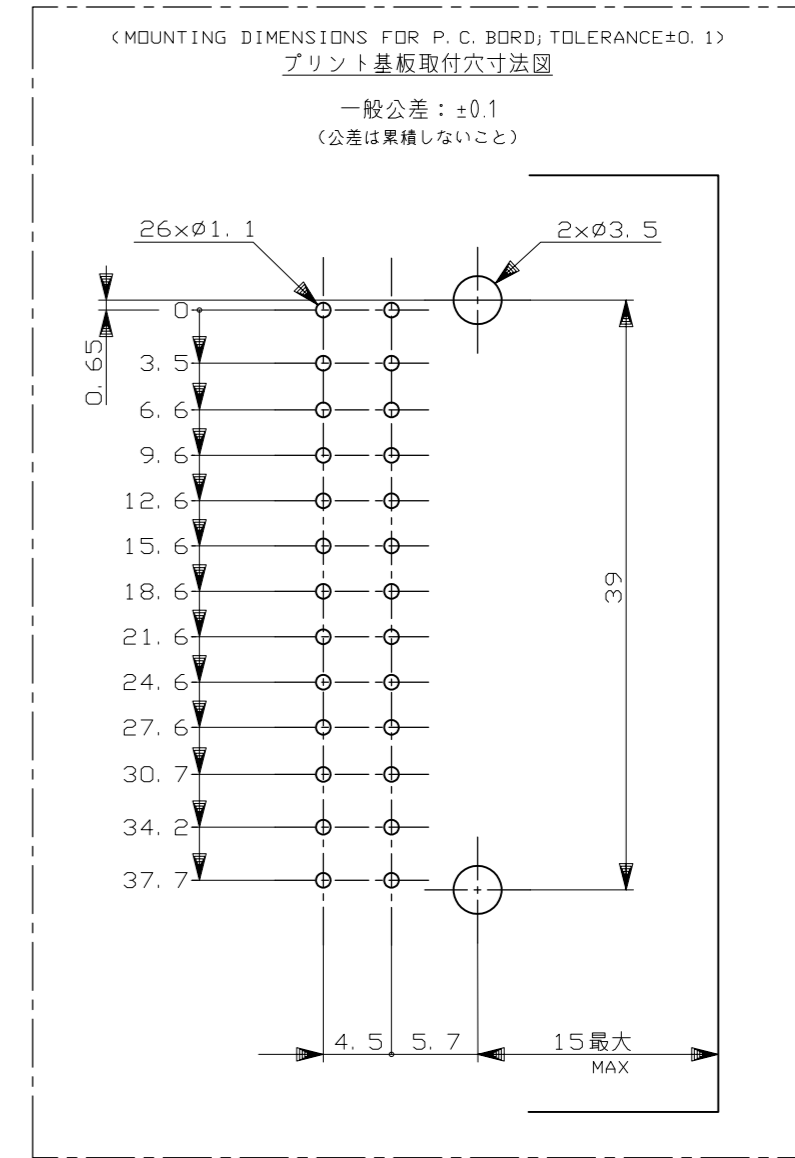
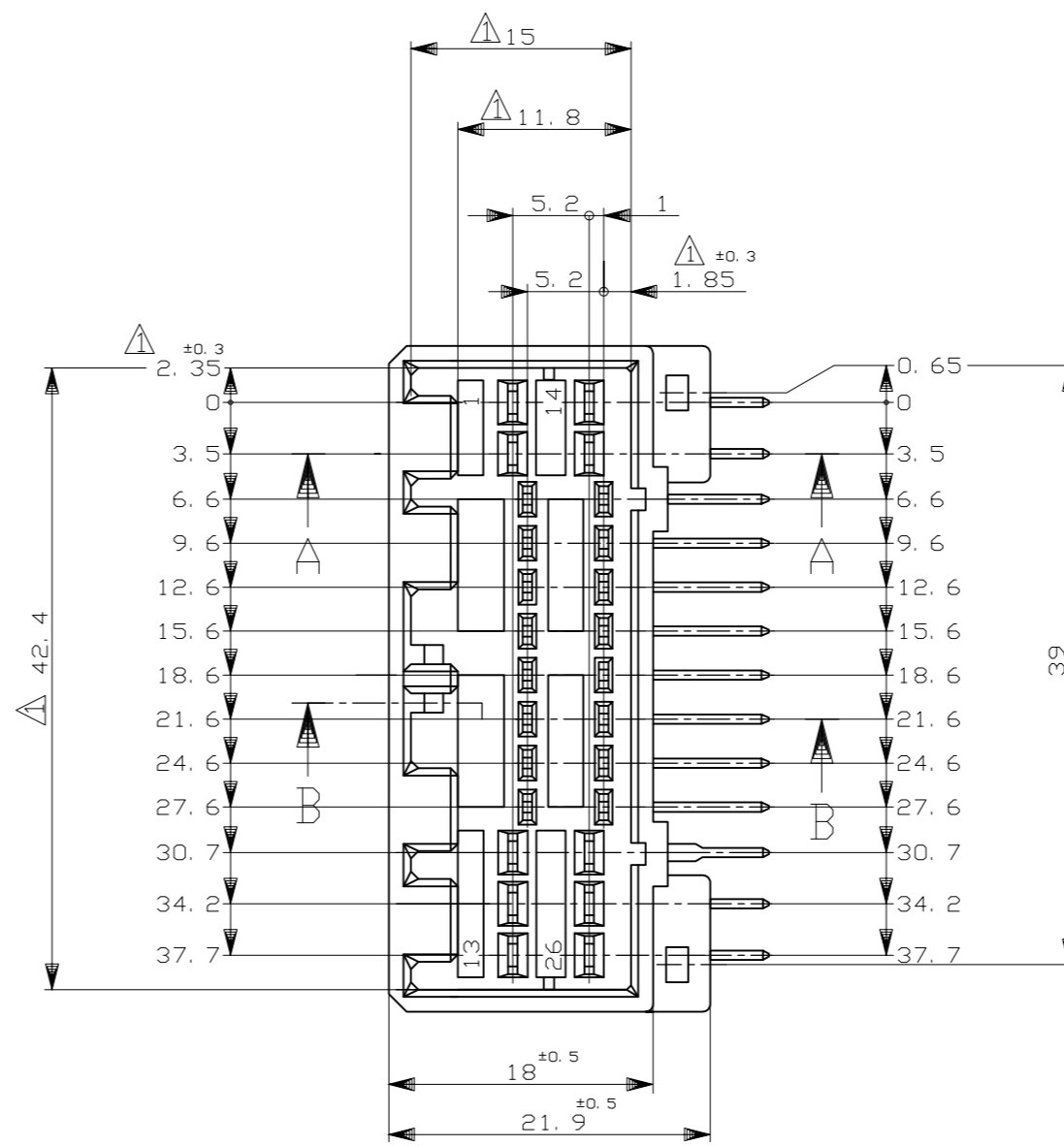
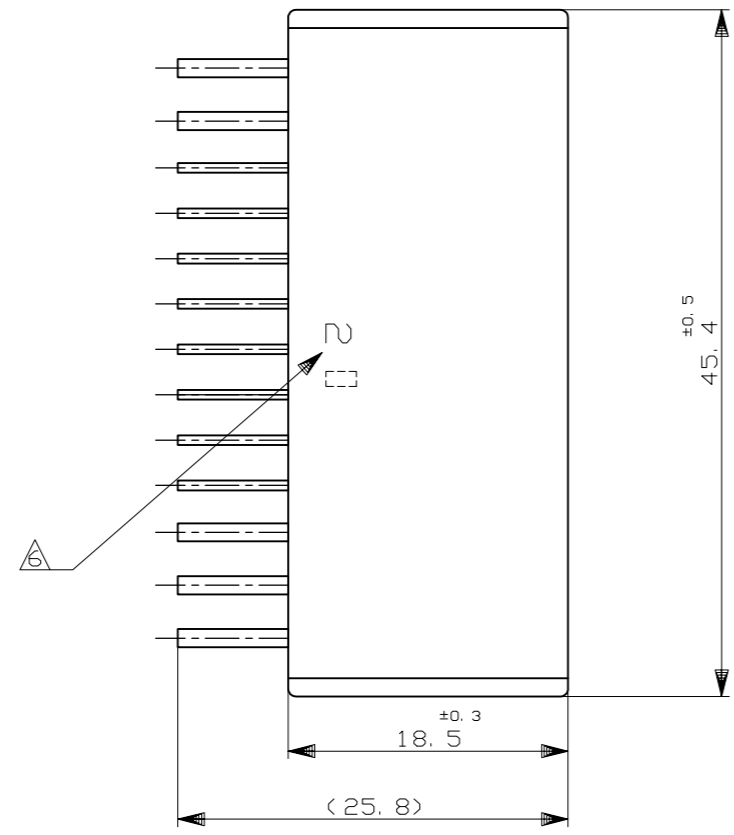
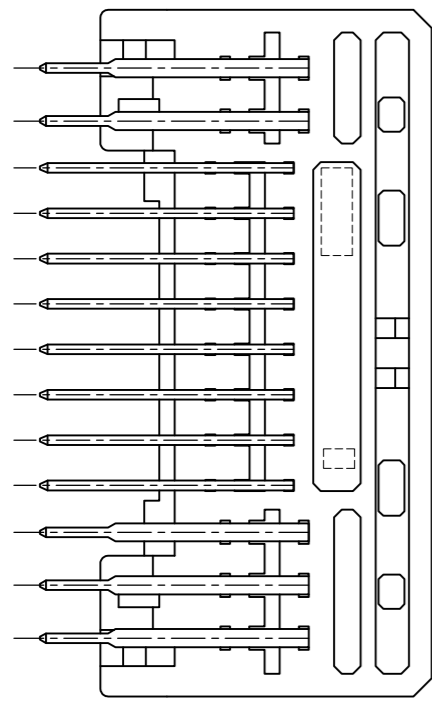
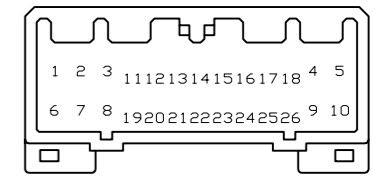

53	SELECTIVE-TIN (MATTE)	SELECTIVE GOLD (部分金めっき) × 6	① ② ④ ⑤ ⑥ ⑦	---	BLUE 青色	3-5175569-5
		PRE-TINNED (錫めっき) × 20				
2	TIN-LEAD	SELECTIVE GOLD (部分金めっき) × 11	③ ⑧	⑫ ~ ⑰, ⑲ ~ ⑳	GRAY 灰色	2-175569-6
		PRE-TINNED (錫めっき) × 15				
0		PRE-TINNED 錫メッキ × 26	---	---	BLUE 青色	175569-5
0		PRE-TINNED 錫メッキ × 26	---	---	GRAY 灰色	175569-6
MARKING マーキング	SOLDERING SIDE 半田付け部	CONTACT SIDE 接触部側	POWER CIRCUIT NO. パワー回路	SIGNAL CIRCUIT NO. シグナル回路	HOUSING COLOR ハウジング色	PART NO
	FINISH OF CONTACT タブ仕上 (本数)		CIRCUIT NO. OF GOLD PLATED CONTACT 全メッキ端子使用回路番号			

THIS DRAWING IS A CONTROLLED DOCUMENT.

DIMENSIONS: 単位: 純 mm	TOLERANCES UNLESS OTHERWISE SPECIFIED 一般公差	DWN T.SHINOHARA 01JUN11	TE Connectivity
TOLERANCES UNLESS OTHERWISE SPECIFIED 一般公差	0 PLC ± 1 PLC ± 2 PLC ± 3 PLC ± 4 PLC ± ANGLES ±	CHK K.BETSUI 01JUN11	
MATERIAL 材料	HOUSING : PBT CONTACT : BRASS	APVD K.BETSUI 01JUN11	NAME 名称
	FINISH 仕上	PRODUCT SPEC 製品規格	26POSITION CAP HOUSING ASSEMBLY 040/070 SERIES HYBRID I/O CONNECTOR
	SEE TABLE 表参照	APPLICATION SPEC 取付適用規格	SIZE A2
		WEIGHT 12 g	CAGE CODE 00779
		CUSTOMER DRAWING	DRAWING NO C=175569
			RESTRICTED TO -
			SCALE 2:1
			SHEET 1 of 1
			REV C3