

MECHANICAL:

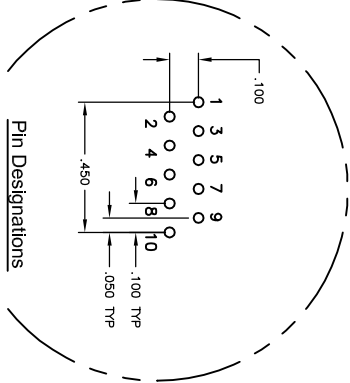

ELECTRICAL:

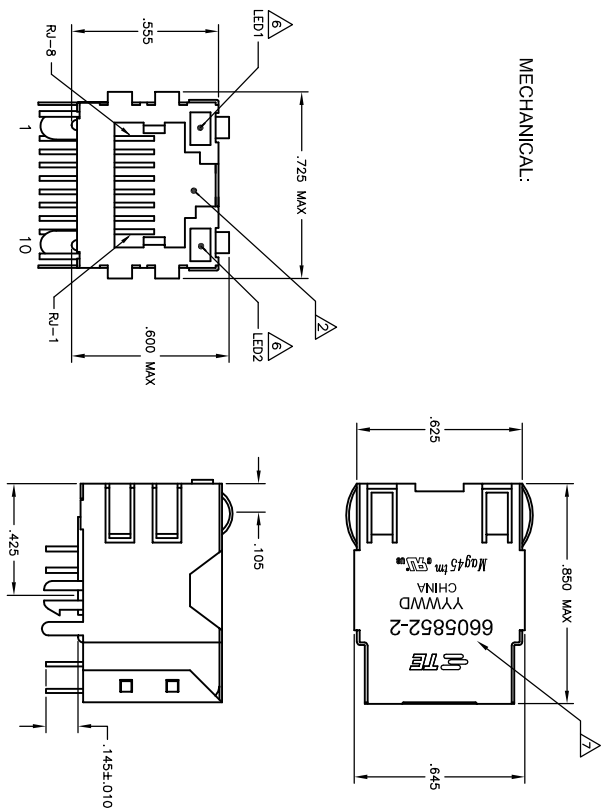
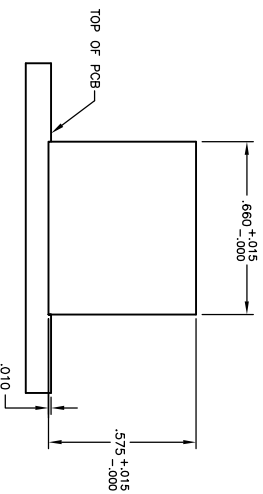
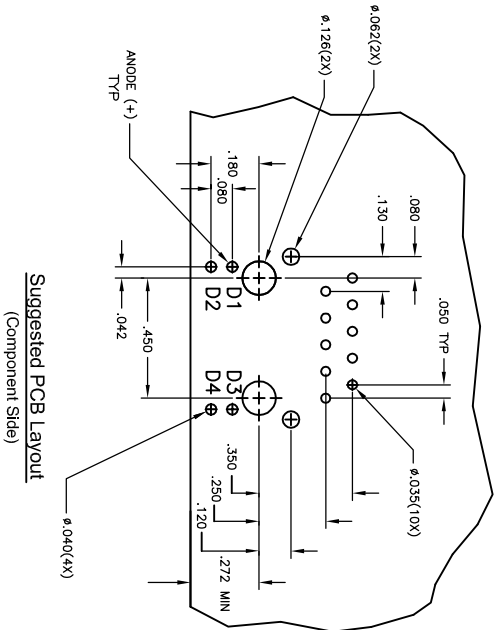
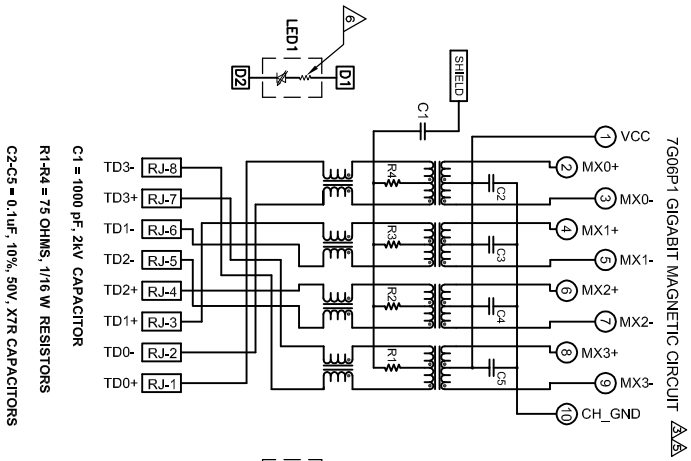

C1 = 1000 pF, 2kV CAPACITOR
 R1-R4 = 75 OHMS, 1/16 W RESISTORS
 C2-C5 = 0.1uF, 10%, 50V, X7R CAPACITORS

MATERIALS:
 -HOUSING - THERMOPLASTIC PET POLYESTER FLAMMABILITY RATING UL 94V-0
 -SHIELD - .010" THICK, C26800 BRASS PREPLATED WITH 30µINCH MIN SEMI-BRIGHT NICKEL, SOLDER TABS POST DIPPED WITH 100µINCH MIN SAC SOLDER.
 -HOD JACK CONTACTS - 0.0157" x 0.018" PHOSPHOR BRONZE, 50µINCH MIN OVERALL NICKEL UNDERPLATE, WITH SELECT 50µINCH MIN HARD GOLD FINISH PLATE.
 -SOLDER TABS WITH 100µINCH MIN MATE TIN AND/OR SAC SOLDER DIP.
 -LIGHT EMITTING DIODE(LED) - DIFFUSED EPOXY LENS, .020" x .020" CARBON STEEL WIREFRAME LEADS PRE-PLATED WITH 80µINCH SILVER OVER 40µINCH NICKEL UNDERPLATE OVER 40µINCH COPPER UNDERPLATE, POST-PLATED WITH 100µINCH MIN MATE TIN AND/OR SAC SOLDER DIP OR PURE TIN SOLDER DIP.
 -PART 7:
 PLUS JACK CAVITY CONFORMS TO FCC RULES AND REGULATIONS PART 68, SUB PART 7.

MAGNETICS:
 -IMPEDANCE: 100 OHMS
 -TURNS RATIO (CABLE): 1:1 ALL FOUR PAIRS
 -OPEN CIRCUIT INDUCTANCE (OCL): 350pH MIN @100MHz, 0.1VRRMS, 8mA DC BIAS FROM 0°C TO 70°C, ALL FOUR PAIRS
 -ALL FOUR PAIRS BI-DIRECTIONAL
 -PERFORMANCE @ 25°C
 INSERTION LOSS (IL): 1.1dB MAX FROM 0.5MHz TO 100MHz
 RETURN LOSS (RL): 18dB MIN FROM 0.5MHz TO 40MHz
 12-20LOG(F/50)DB MIN FROM 4.0 MHz TO 100MHz
 CROSS TALK ATTENUATION: 35dB MIN FROM 0.5MHz TO 40MHz
 33-20*LOG(F/50)DB MIN FROM 4.0 MHz TO 100MHz
 COMMON MODE REJECTION RATIO (CMRR): 30dB MIN FROM 0.5MHz TO 100MHz
 -ISOLATION VOLTAGE(25VDC (MAX)) FOR 60 SECONDS WITH A RISE TIME OF 500V/SEC.

4. OPERATING TEMPERATURE: FROM 0°C - +70°C.
 THE MAGNETICS ARE SYMMETRICAL, AND SUPPORTS AUTO-MD/MDX.
 LEADS WITH BUILT-IN RESISTOR
 LEADS ARE DRIVEN WITH 5V VOLTAGE AND THE MAX OPERATING CURRENT IS 20mA.
 LED COLOR: DOMINANT WAVELENGTH (NM): GREEN 568 nm TYP @ VF=5V
 FORWARD CURRENT (IF): GREEN 75mA TYP @ VF=5V
 DOMINANT WAVELENGTH (NM): YELLOW 588 nm TYP @ VF=5V
 FORWARD CURRENT (IF): YELLOW 15mA TYP @ VF=5V
 TE CONNECTIVITY LOGO, PART NUMBER, DATE CODE, COUNTRY OF ORIGIN AND AGENCY APPROVAL MARKING IN APPROXIMATE LOCATION SHOWN.
 8. THESE PARTS ARE RECOMMENDED FOR WAVE SOLDERING PROCESS. PREHEAT TEMPERATURE IS 120°C TO 60°C, 120 SECONDS TO 180 SECONDS. PEAK WAVE SOLDERING TEMPERATURE IS 260°C MAX, 10 SECONDS MAX.

THIS DRAWING IS A CONTROLLED DOCUMENT.

REVISION	DATE	DESCRIPTION	BY	CHK
1	2019-08-22	ISSUE FOR PRODUCTION	AL	AL
2	2019-08-22	REVISED TO ADD DIMENSIONS	AL	AL
3	2019-08-22	REVISED TO ADD DIMENSIONS	AL	AL
4	2019-08-22	REVISED TO ADD DIMENSIONS	AL	AL
5	2019-08-22	REVISED TO ADD DIMENSIONS	AL	AL
6	2019-08-22	REVISED TO ADD DIMENSIONS	AL	AL
7	2019-08-22	REVISED TO ADD DIMENSIONS	AL	AL
8	2019-08-22	REVISED TO ADD DIMENSIONS	AL	AL

1X1 MAG45(N), 7G4P1 GIGABIT ETHERNET SCHEMATIC, 7G06P1 MAGNETIC CIRCUIT, SHIELD, DECOUPLING CAPACITOR, WITH RESISTOR LEADS

TE Connectivity

6605852-2

108-2100

100779C-6605852