

REV	ECN	APPD
-	4800	



RATINGS

CURRENT - 12A
 VOLTAGE - 150V
 U.L. FILE NO.



RATINGS

CURRENT - 12A
 VOLTAGE - 150V
 CSA FILE NO.

DIN VDE 0627:1986
 DIN VDE 0110-1:1989
 EN 60947-1:1991
 EN 60947-7-1:1992

CURRENT - 12A
 VOLTAGE - 130V
 TUV FILE NO.

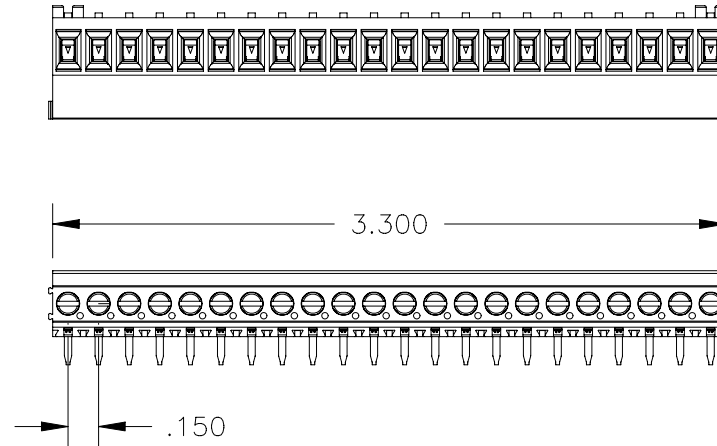
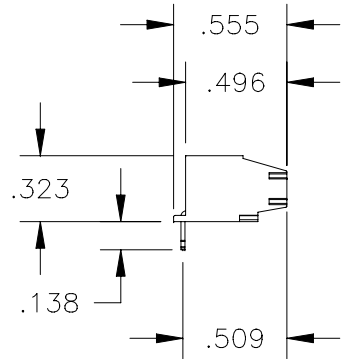

INSTALLATION
 RECOMMENDATIONS

WIRE RANGE: 14-30 AWG
 WIRE STRIP LENGTH: .200-.240
 TIGHTENING TORQUE: 2.2 LB-IN.

MATERIALS

HOUSING: POLYAMIDE 6/6, COLOR: BLACK
 CONTACT: COPPER ALLOY, TIN PLATED
 SCREW / CAGE CLAMP: COPPER ALLOY, NICKEL PLATED

OPERATING TEMPERATURE RANGE: -40°C TO 110°C
 RECOMMENDED PCB THICKNESS: .094 MAX

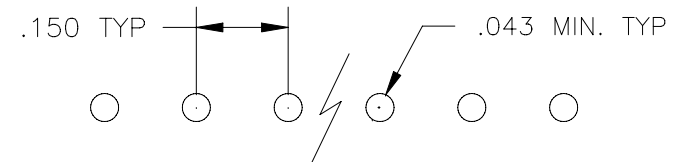

DIMENSIONS

ANSI Y14.5M
 UNITS: INCHES
 ACAD FILE

TOLERANCES

.XX ± .01
 .XXX ± .005
 ANGLES ± 2°

PROJECTION

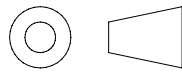

SPECIFICATION
 DRAWING

ENGR
 I. QUINN 3/20/02

CHKD

APPD



TITLE

ESRM TERMINAL BLOCK
 22 POSITION VERTICAL
 .150 [3.81mm] PITCH

ORIGINAL
 STAMPED
 IN RED

THIS DOCUMENT CONTAINS
 PROPRIETARY INFORMATION WHICH
 IS THE CONFIDENTIAL PROPERTY
 OF PCD, INC. PEABODY, MA, USA

SIZE DWG NO.

A

ESRM22290

REV

-

CODE: 58982

SCALE: NONE

SHEET 1 OF 1